

FOR LEASE







3700 Plank Road





Fredericksburg, VA 22407

Overview

3700 Plank Road sits at the center of the Plank Road / Route 3 retail corridor — Spotsylvania County’s dominant trade area and one of the busiest stretches of retail along I-95 between Richmond, VA and Washington, D.C. The property delivers prominent frontage on Plank Road at 57,000 AADT, with I-95 (165,000 AADT) less than a mile east. Surrounding retail includes Spotsylvania Town Centre, Central Park Marketplace, Spotsylvania Crossing, and BJ’s Wholesale — anchoring one of the densest retail clusters in the I-95 South corridor.

Quick Facts

Availability	Immediate
Size	Up to 46,415 square feet (divisible)
Ceiling Heights	Picklr space: 20’-5”; Sofa Outlet space: 13’-10”
Rental Rate	TBD
Net Charges	\$1.41 psf NNN (CAM: \$0.52 psf; INS: \$0.30 psf; TAX: \$0.59 psf)
Nearby Tenants	   

2025 Demographics	1 mile	3 miles	5 miles
 POPULATION	6,865	58,987	135,794
 HOUSEHOLDS	2,507	21,838	50,191
 AVG. HH INCOME	\$113,164	\$128,230	\$136,818
 DAYTIME POPULATION	6,387	62,189	128,412
 TRAFFIC COUNT	165,000 AADT (I-95N)	57,000 AADT (Plank Rd)	



Plank Rd



3

AVAILABLE
UP TO 46,415 SF
(DIVISIBLE)

SPORTSMANS
WAREHOUSE

Taskforce Dr

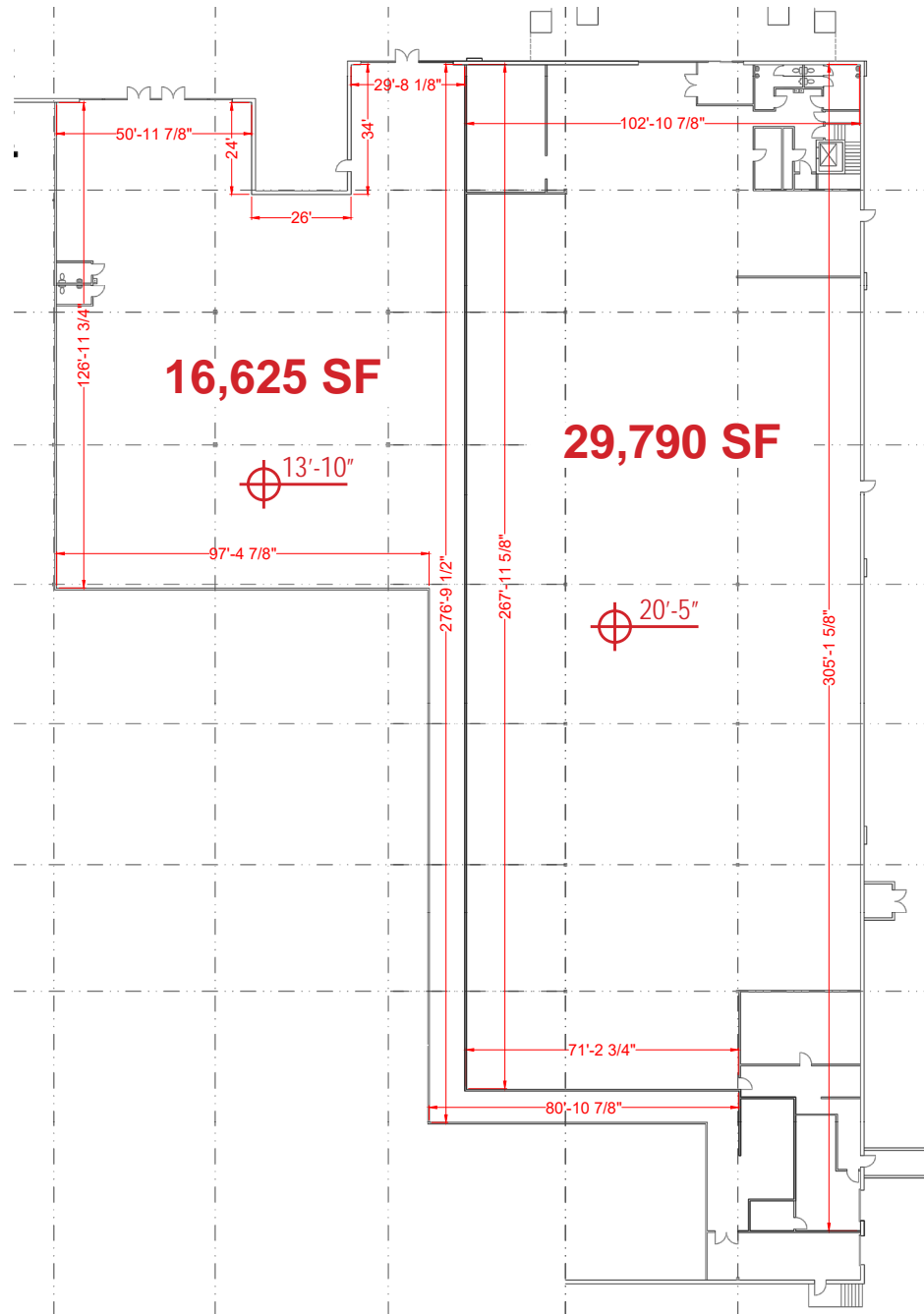

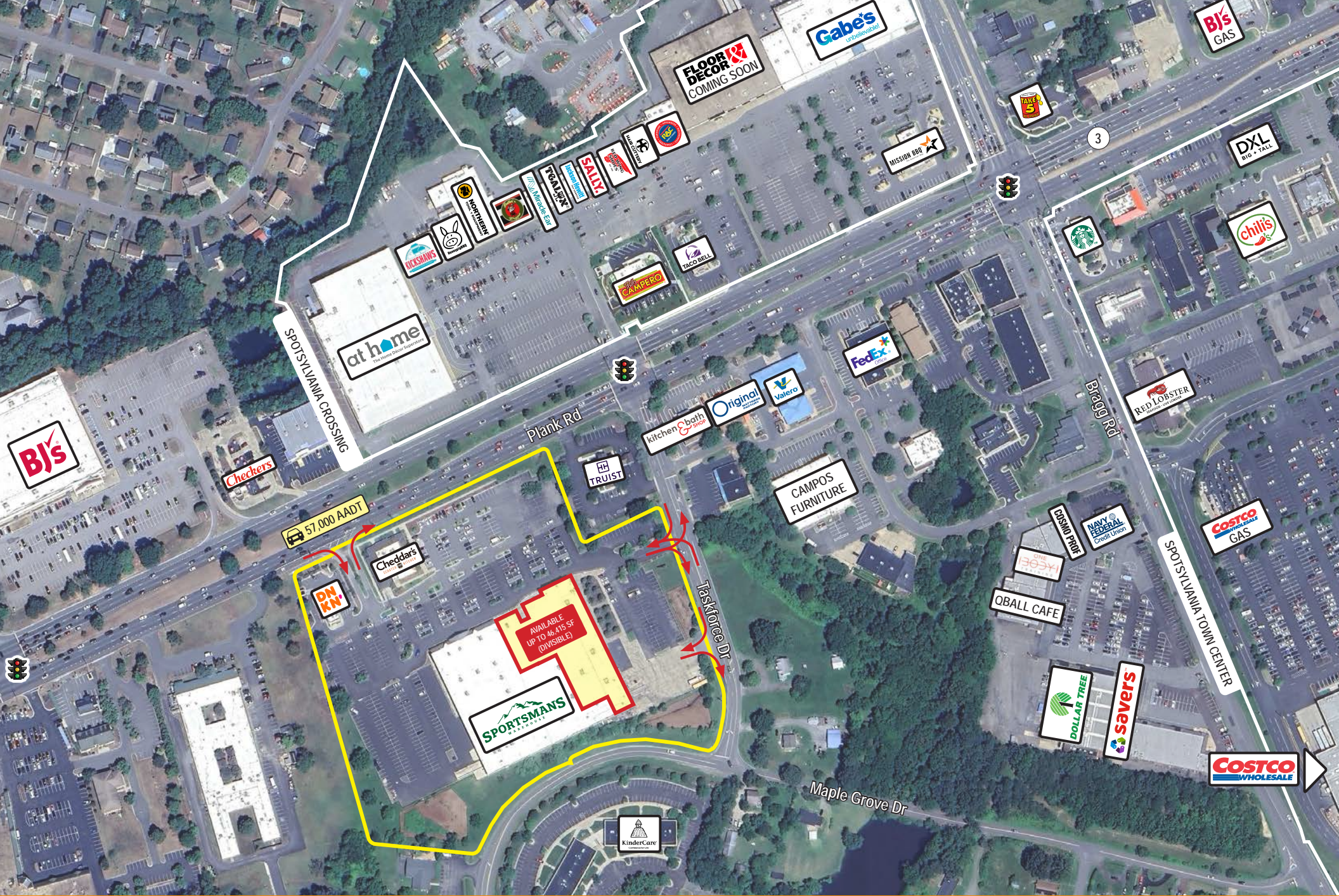

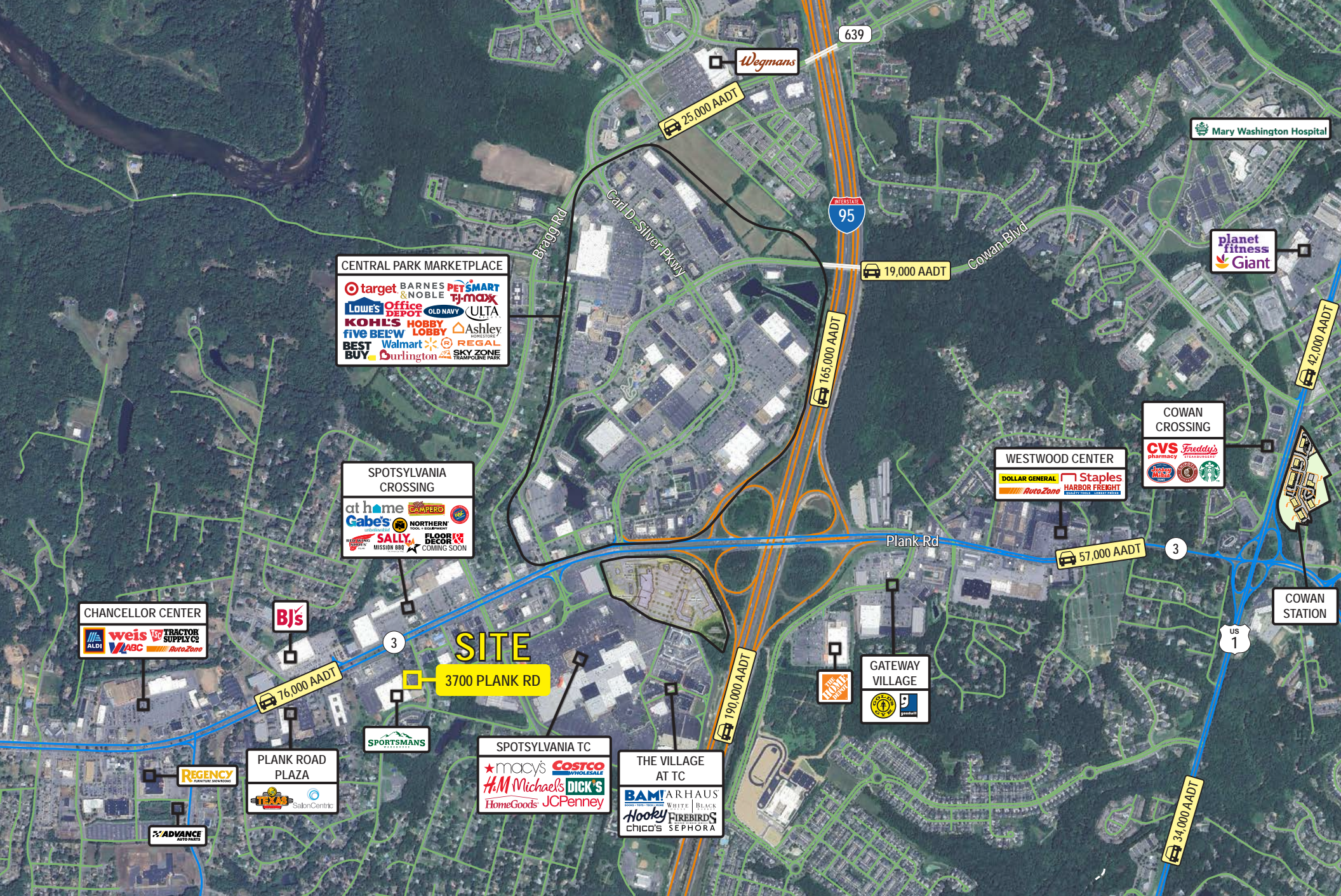

Interested? Contact:

Spotty Robins

✉ srobins@segallgroup.com

☎ 804.207.4040

📱 804.339.9525

Trey Blankinship

✉ tblankinship@segallgroup.com

☎ 804.207.4040

📱 804.516.1205

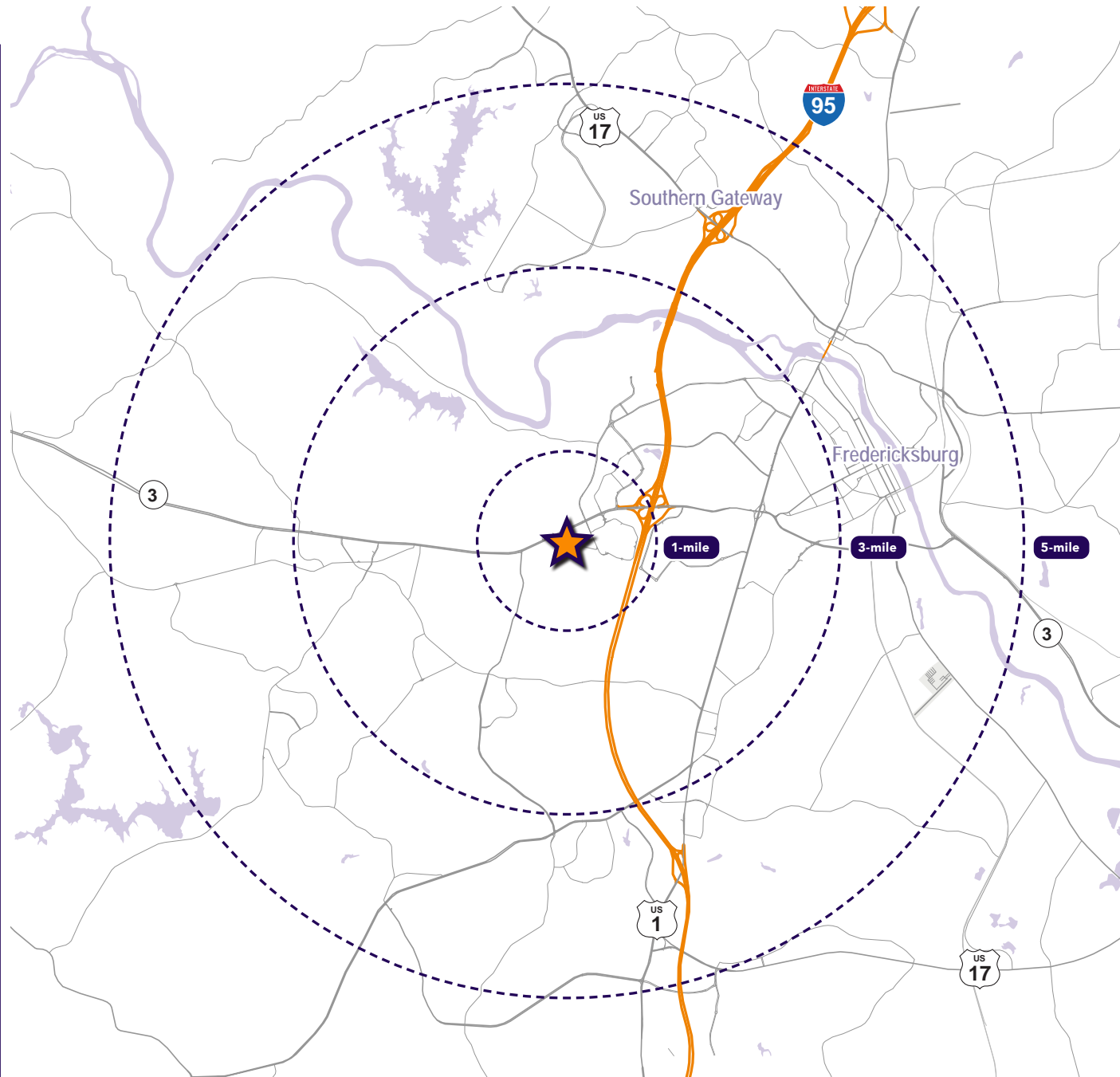

Maryland

605 South Eden Street
Suite 200
Baltimore, MD 21231
410.753.3000

DC • Northern VA

8245 Boone Boulevard
Suite 200
Tysons, VA 22182
202.833.3830

Richmond

4701 Cox Road
Suite 100
Glen Allen, VA 23060
804.207.4040

Online

www.segallgroup.com

Member of
REALTY RESOURCES

**RETAIL
READY.**

segall
GROUP