

FOR LEASE



# 12 E Ordinance Road

Glen Burnie, MD 21060

## Overview

Located in the heart of Glen Burnie's regional retail node, the building is a rare free-standing opportunity near the intersection of Ritchie Highway and Ordinance Road. The property is well-positioned in a dense and established trade area that benefits from strong visibility, convenient access to major highways, and proximity to a wide range of national retailers and residential communities. The existing improvements offer a flexible layout suitable for a variety of retail, showroom, or service-oriented users.

## Quick Facts

- Availability** Immediate
- Size** 11,229 square feet
- Rental Rate** Negotiable
- Net Charges** CAM - \$1.65 psf; INS - \$0.52 psf; TAX - \$1.69 psf
- Parking** 21 spaces (right to cross park on adjacent Expressway Shopping Center)
- Co-Tenants** **CHARLEYS** cricket Ledo Pizza SalonCentric

2025 Demographics	1 mile	3 miles	5 miles
POPULATION	<b>13,427</b>	<b>85,488</b>	<b>187,148</b>
HOUSEHOLDS	<b>5,330</b>	<b>31,628</b>	<b>69,980</b>
AVG. HH INCOME	<b>\$98,518</b>	<b>\$108,460</b>	<b>\$109,858</b>
DAYTIME POPULATION	<b>8,598</b>	<b>87,494</b>	<b>214,150</b>
TRAFFIC COUNT	<b>21,980 AADT</b> (East Ordinance Road)	<b>38,451 AADT</b> (Gov. Ritchie Highway)	

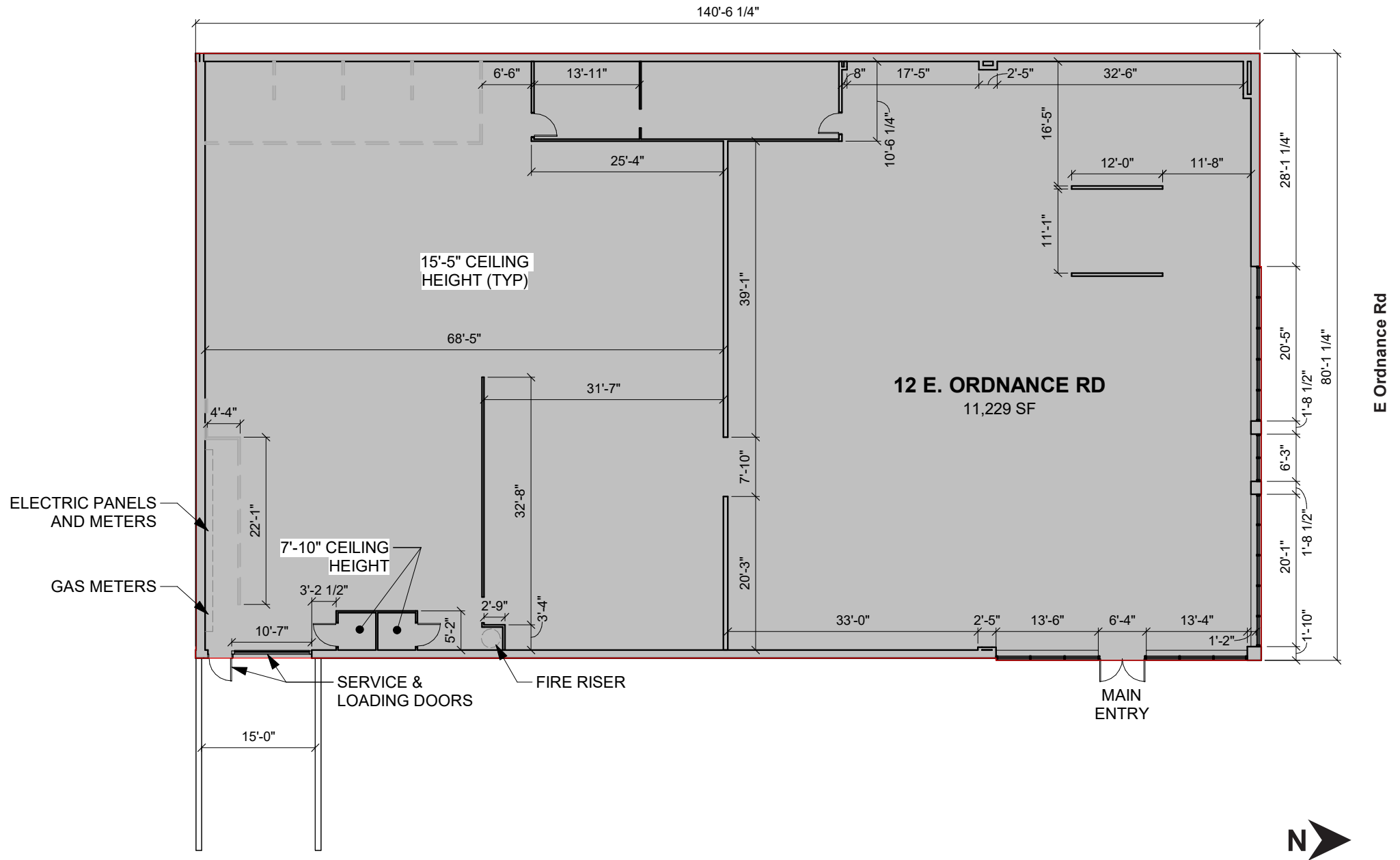





GOVERNOR PLAZA

2

E Ordance Rd

21,980 AADT

38,451 AADT

EXPRESSWAY SC

Chesapeake Center Dr

THE CENTRE AT GLEN BURNIE



# Interested? Contact:

## Andrew Segall

✉ asegall@segallgroup.com

☎ 410.753.3947

📱 410.960.0361

## Marcelo Grosberg

✉ mgrosberg@segallgroup.com

☎ 410.753.3948

📱 443.927.6100

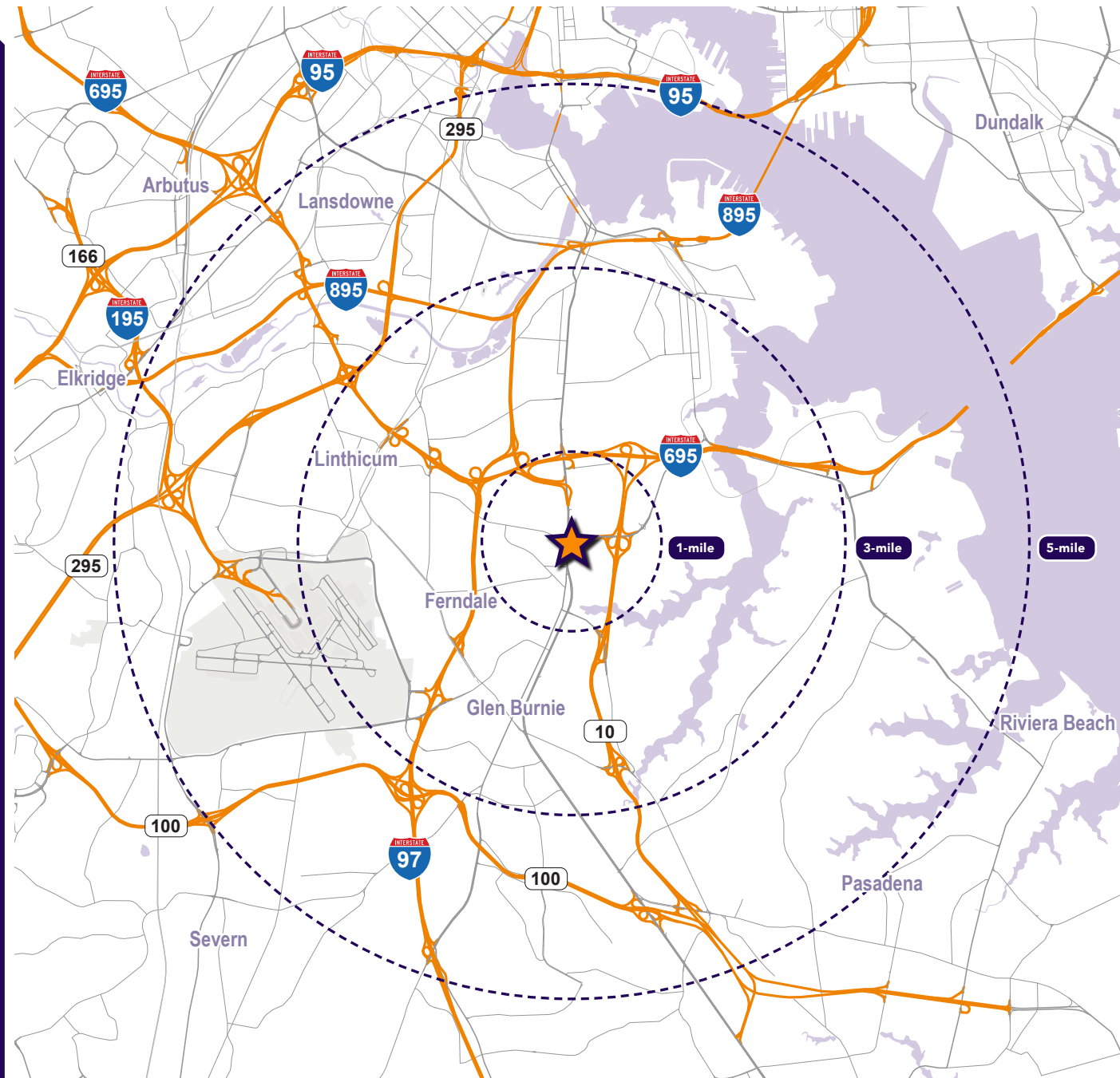

### Maryland

605 South Eden Street  
Suite 200  
Baltimore, MD 21231  
410.753.3000

### DC • Northern VA

8245 Boone Boulevard  
Suite 200  
Tysons, VA 22182  
202.833.3830

### Richmond

4701 Cox Road  
Suite 100  
Glen Allen, VA 23060  
804.207.4040

### Online

www.segallgroup.com

Member of  
**REALTY RESOURCES**

**RETAIL  
READY.**