

**FOR LEASE** Available Summer 2025



# Shoppes at Riva





2557 Riva Road, Annapolis, MD 21401

## Overview

6,260 square foot proposed retail building with signalized access near the corner of Riva Road and Admiral Cochrane Drive in Annapolis, MD. The site will have outstanding visibility and access, and is situated in a heavily trafficked area near Anne Arundel County Offices, Annapolis High School and numerous hotel and new residential developments, including a new 250 unit apartment building immediately adjacent.

## Quick Facts

Availability	Summer 2025
Size	1,440 - 3,860 square feet
Rental Rate	TBD
Net Charges	\$8.50 per square foot (estimated)

2023 Demographics	1 mile	3 miles	5 miles
 POPULATION	5,739	49,163	100,442
 HOUSEHOLDS	2,882	20,922	41,176
 AVG. HH INCOME	\$140,999	\$143,540	\$144,452
 DAYTIME POPULATION	15,985	79,993	153,225
 TRAFFIC COUNT	19,611 AADT (Riva Road)	64,843 AADT (Aris T Allen Boulevard)	

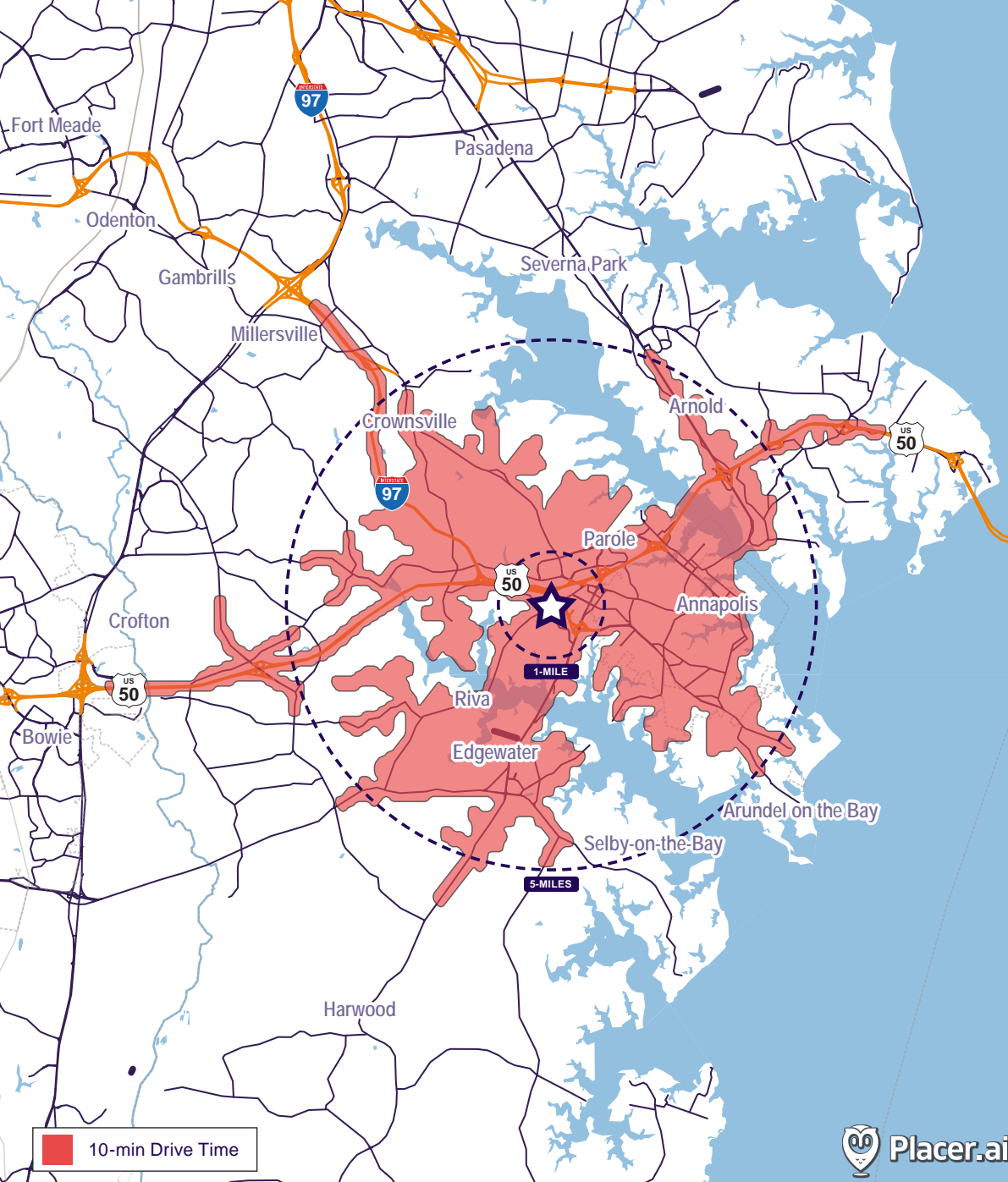

## Demographics (10 Min DT):



POPULATION

**73,974**



HOUSEHOLDS

**30,309**



AVERAGE HH INCOME

**\$139,840**



DAYTIME POPULATION

**154,494**



HIGH SCHOOL GRADUATE  
OR HIGHER

**92.1%**



EMPLOYEES

**77,770**

## TAPESTRY PROFILE (1-MILE):



**C - Booming with Confidence**

**31.8%**

Prosperous, established couples in their peak earning years living in suburban homes



**A - Power Elite**

**21.9%**

The wealthiest households in the US, living in the most exclusive neighborhoods, and enjoying all that life has to offer



**K - Significant Singles**

**14.2%**

Diversely aged singles earning mid-scale incomes supporting active city styles of living



**E - Thriving Boomers**

**8.3%**

Upper-middle-class baby boomer-age couples living comfortable lifestyles settled in suburban homes



**Q - Golden Year Guardians**

**7.8%**

Retirees living in old homes, settled residences and communities



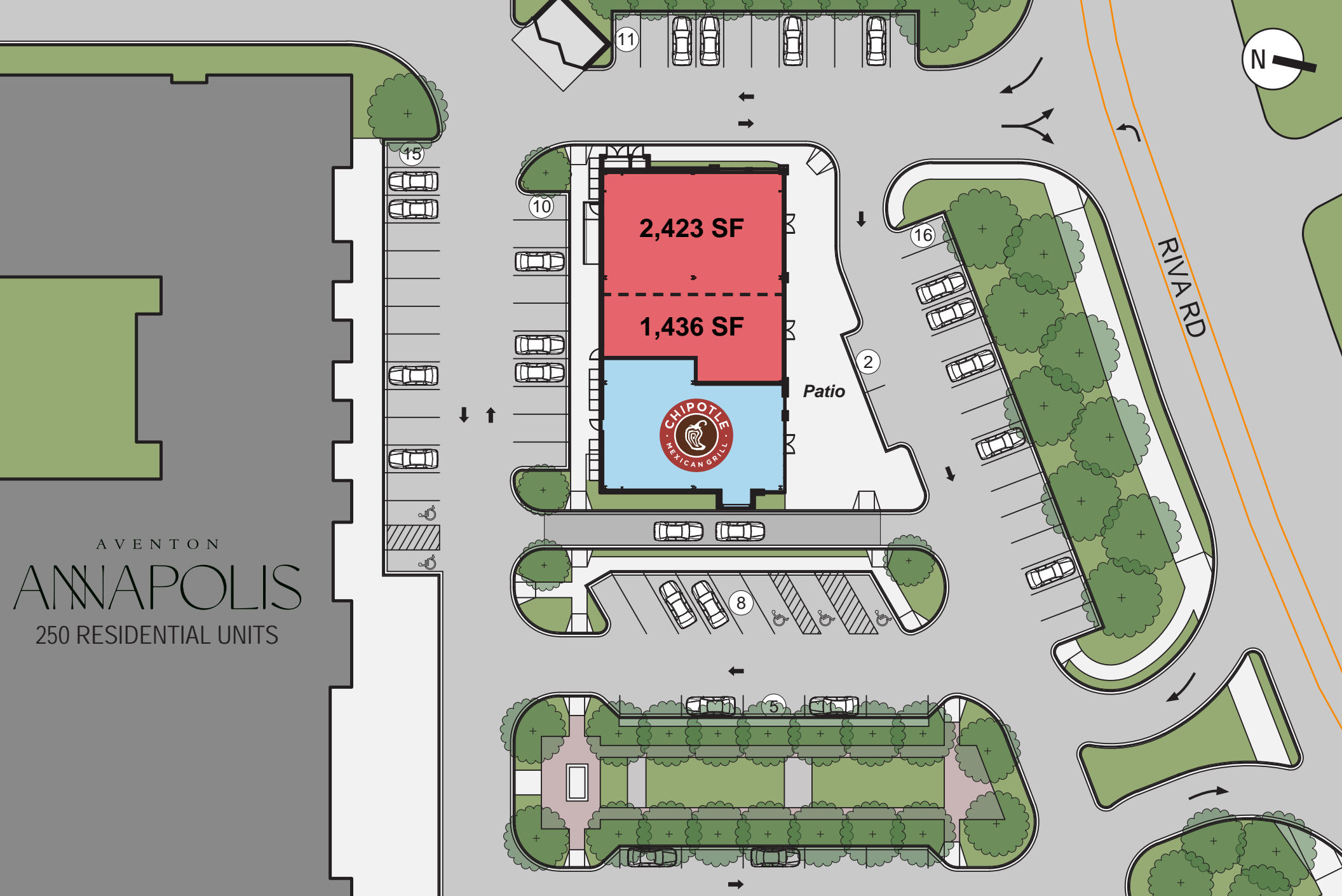













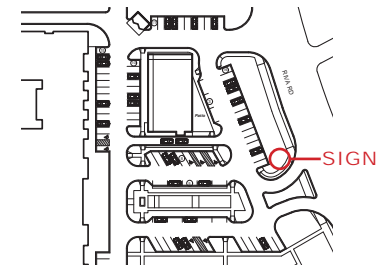
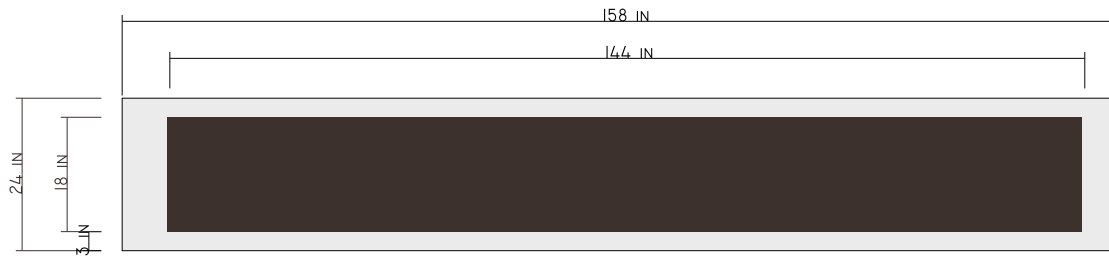



250 UNITS



- Saltwater Pool with Sunshelf
- Al Fresco Dining Pergola with Electric Grills in Both Courtyards
- Grand Double Height Lobby with Water Vapor Fireplace
- Four Private Offices, Conference Room and Podcast Studio
- State-of-the-Art Fitness Center

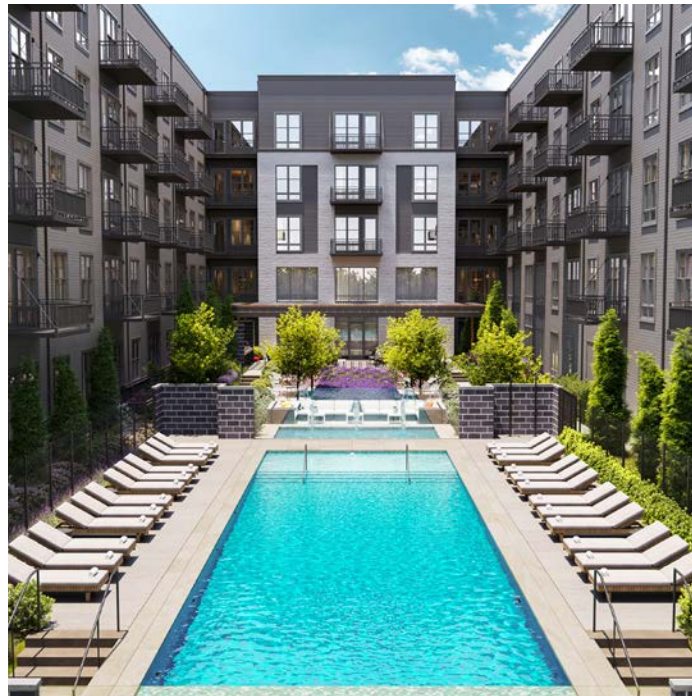
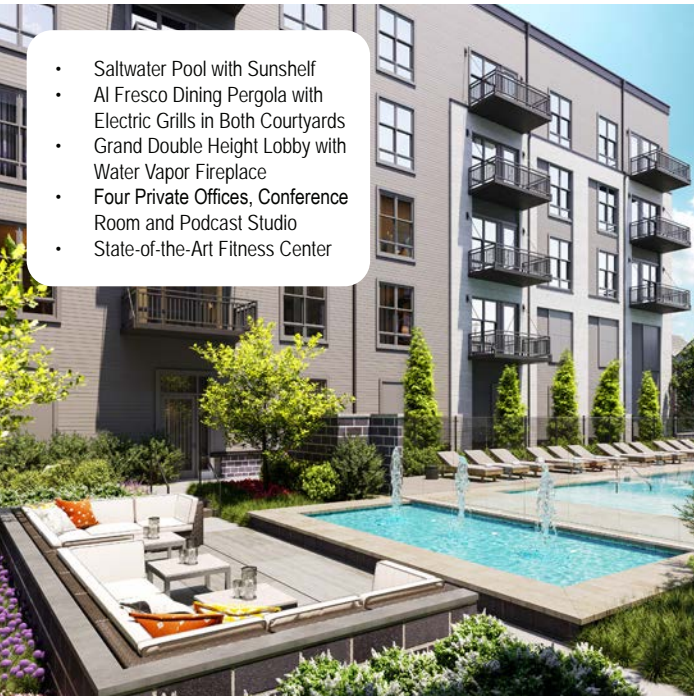

- Controlled Access Building with Parking Garage
- Electric Vehicle Charging Stations
- Smart Package System with 24/7 Access
- Pet-Friendly Community with Pet Spa and Dog Park
- Game Room with Pool Table, Shuffleboard and Arcade Games





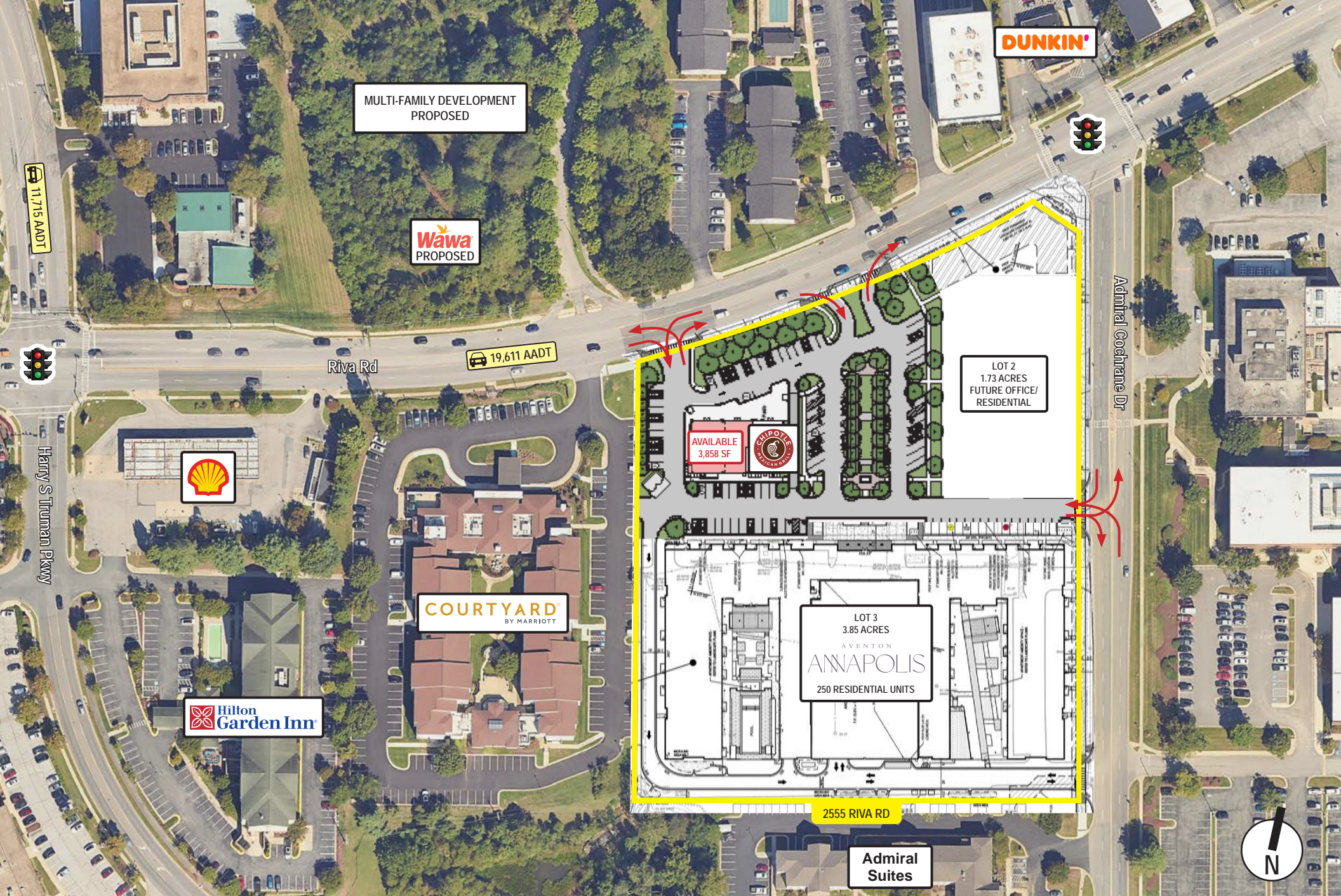



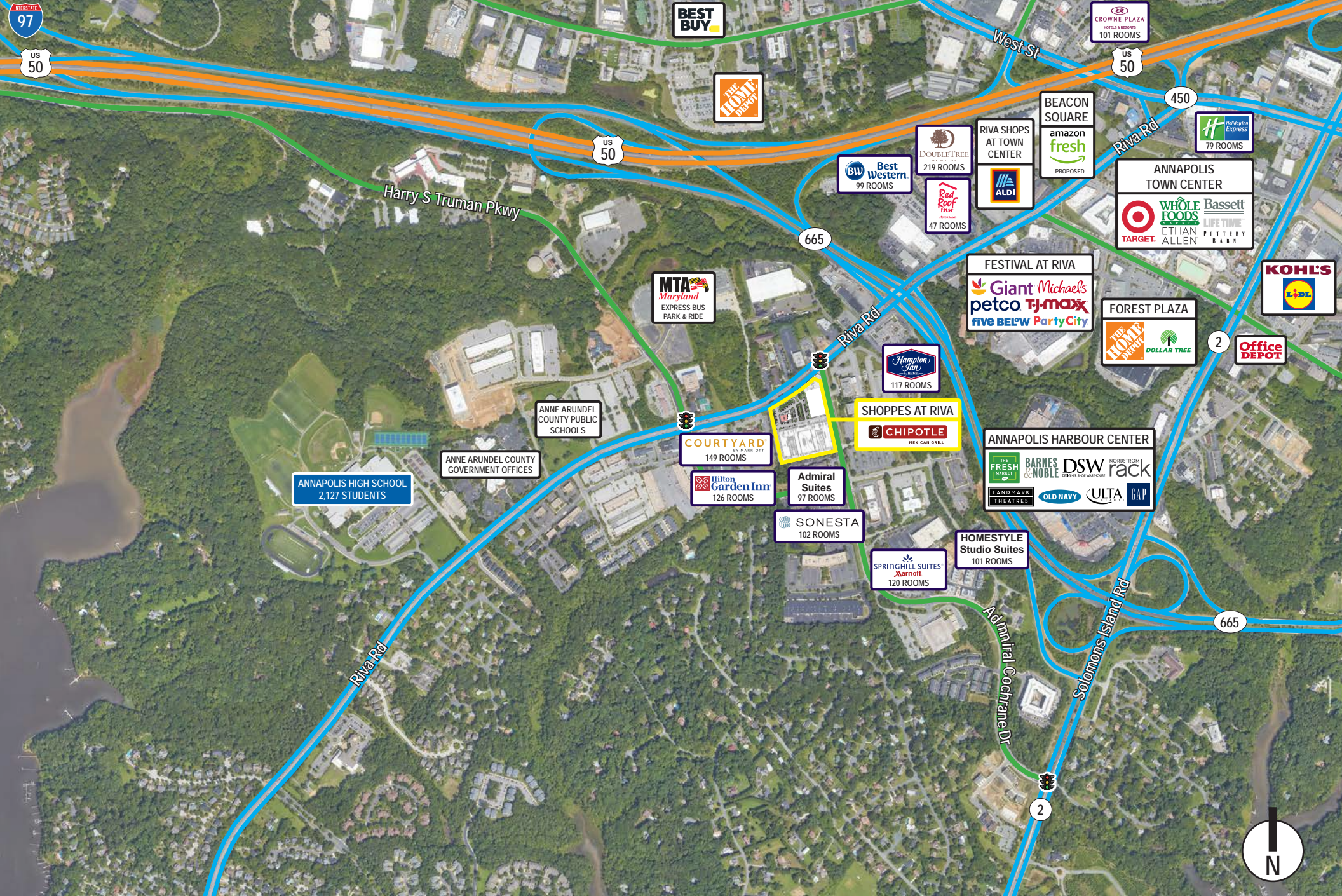



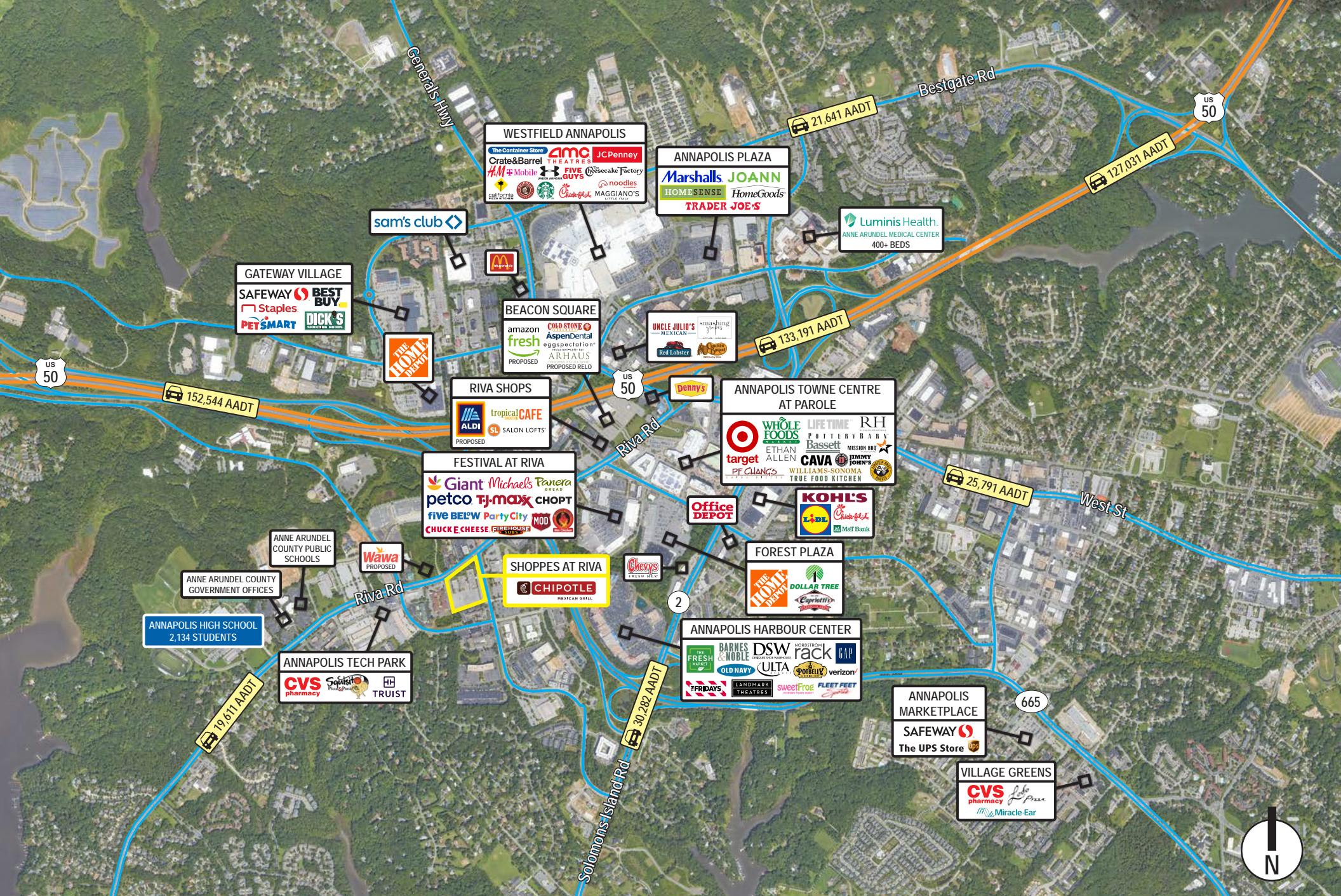



# Interested? Contact:

## Jonathan Garritt

✉ jgarritt@segallgroup.com

☎ 410.753.3942

📞 443.223.0662

## Andrew Segall

✉ asegall@segallgroup.com

☎ 410.753.3947

📞 443.960.0361

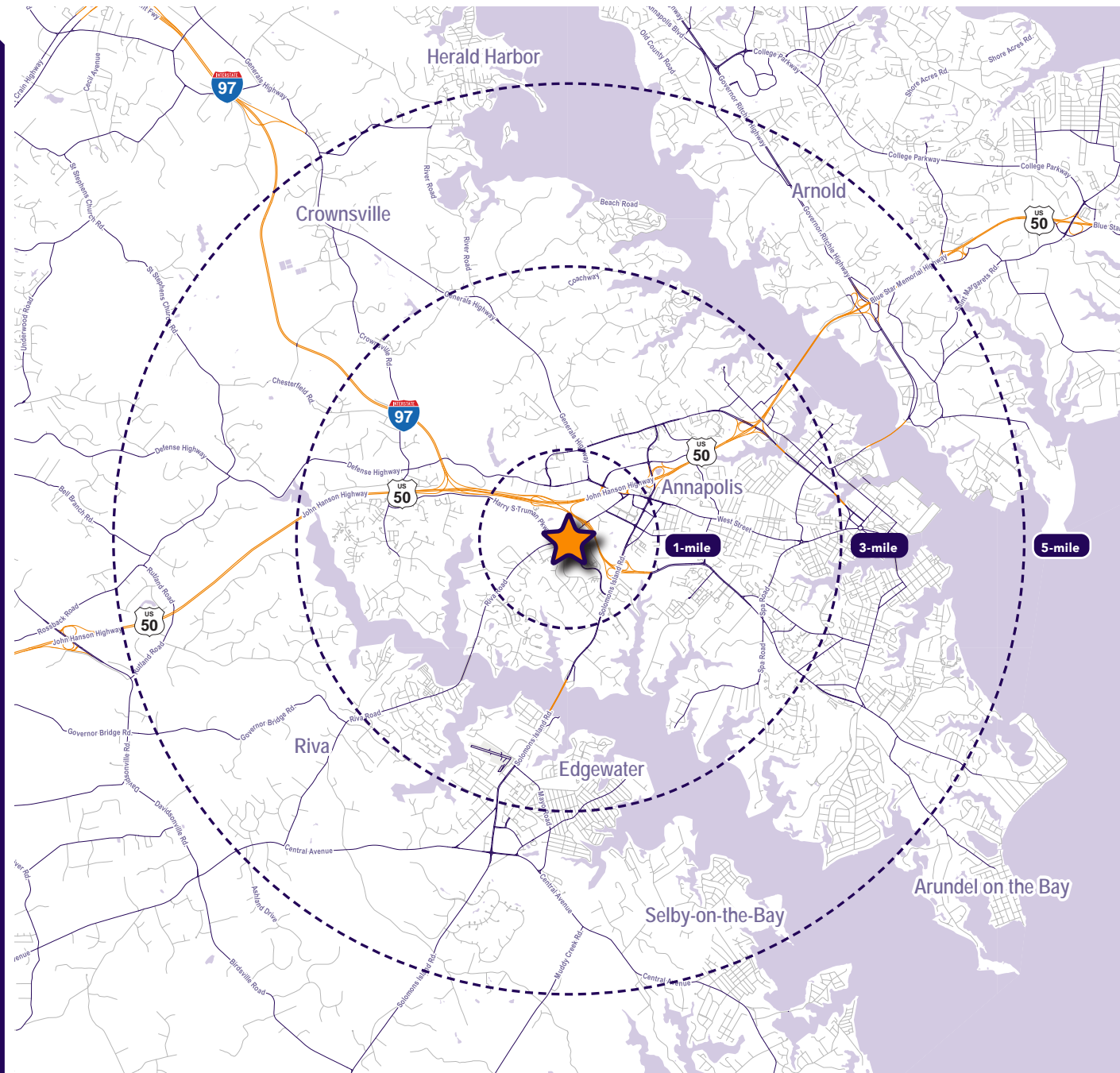

### Maryland

605 South Eden Street  
Suite 200  
Baltimore, MD 21231  
410.753.3000

### DC • Northern VA

8245 Boone Boulevard  
Suite 800  
Tysons, VA 22182  
202.833.3830

### Richmond

4870 Sadler Road  
Suite 300  
Glen Allen, VA 23060  
804.336.2501

### Online

www.segallgroup.com

### Member of

**REALTY**  
RESOURCES

**RETAIL**  
**READY.**

**segall**  
GROUP