

FOR LEASE Available Summer 2025



Shoppes at Riva





2557 Riva Road, Annapolis, MD 21401

Overview

6,260 square foot retail building with signaled access near the corner of Riva Road and Admiral Cochrane Drive in Annapolis, MD. The site will have outstanding visibility and access, and is situated in a heavily trafficked area near Anne Arundel County Offices, Annapolis High School and numerous hotel and new residential developments, including a new 250 unit apartment building immediately adjacent.

Quick Facts

Availability	Summer 2025
Size	1,157 square feet
Rental Rate	TBD
Net Charges	\$8.50 per square foot (estimated)

2024 Demographics	1 mile	3 miles	5 miles
 POPULATION	5,964	49,148	100,138
 HOUSEHOLDS	3,018	20,863	40,994
 AVG. HH INCOME	\$167,678	\$167,576	\$175,096
 DAYTIME POPULATION	16,257	89,641	160,204
 TRAFFIC COUNT	19,611 AADT (Riva Road)	64,843 AADT (Aris T Allen Boulevard)	

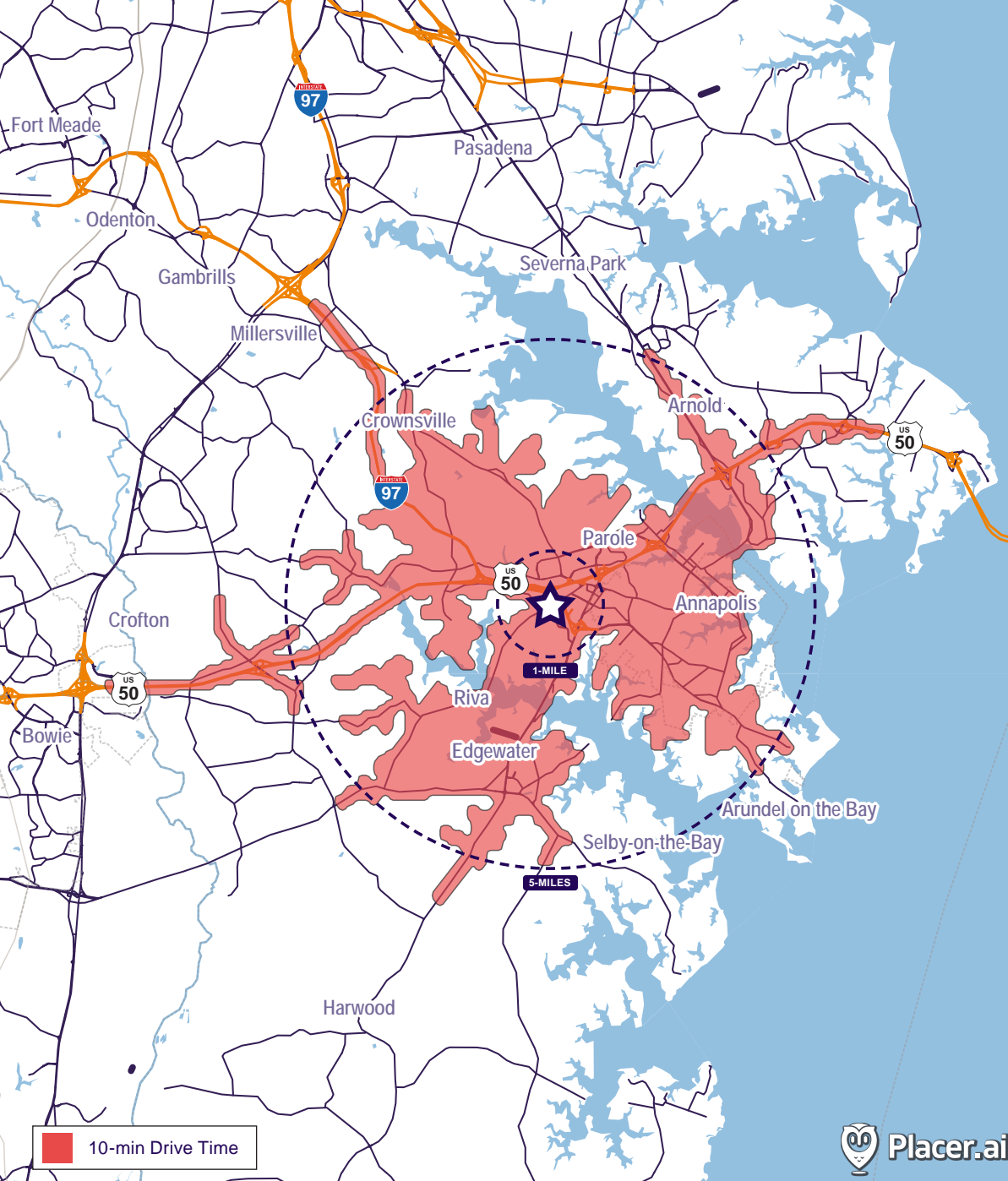

Demographics (10 Min DT):

	POPULATION	73,693
	HOUSEHOLDS	30,144
	AVERAGE HH INCOME	\$165,466
	DAYTIME POPULATION	124,847
	HIGH SCHOOL GRADUATE OR HIGHER	93.4%
	EMPLOYEES	82,982

TAPESTRY PROFILE (1-MILE):

	C - Booming with Confidence	33.3%
	Prosperous, established couples in their peak earning years living in suburban homes	
	K - Significant Singles	20%
	Diversely aged singles earning mid-scale incomes supporting active city styles of living	
	A - Power Elite	16.8%
	The wealthiest households in the US, living in the most exclusive neighborhoods, and enjoying all that life has to offer	
	Q - Golden Year Guardians	13.6%
	Retirees living in old homes, settled residences and communities	
	E - Thriving Boomers	5.1%
	Upper-middle-class baby boomer-age couples living comfortable lifestyles settled in suburban homes	

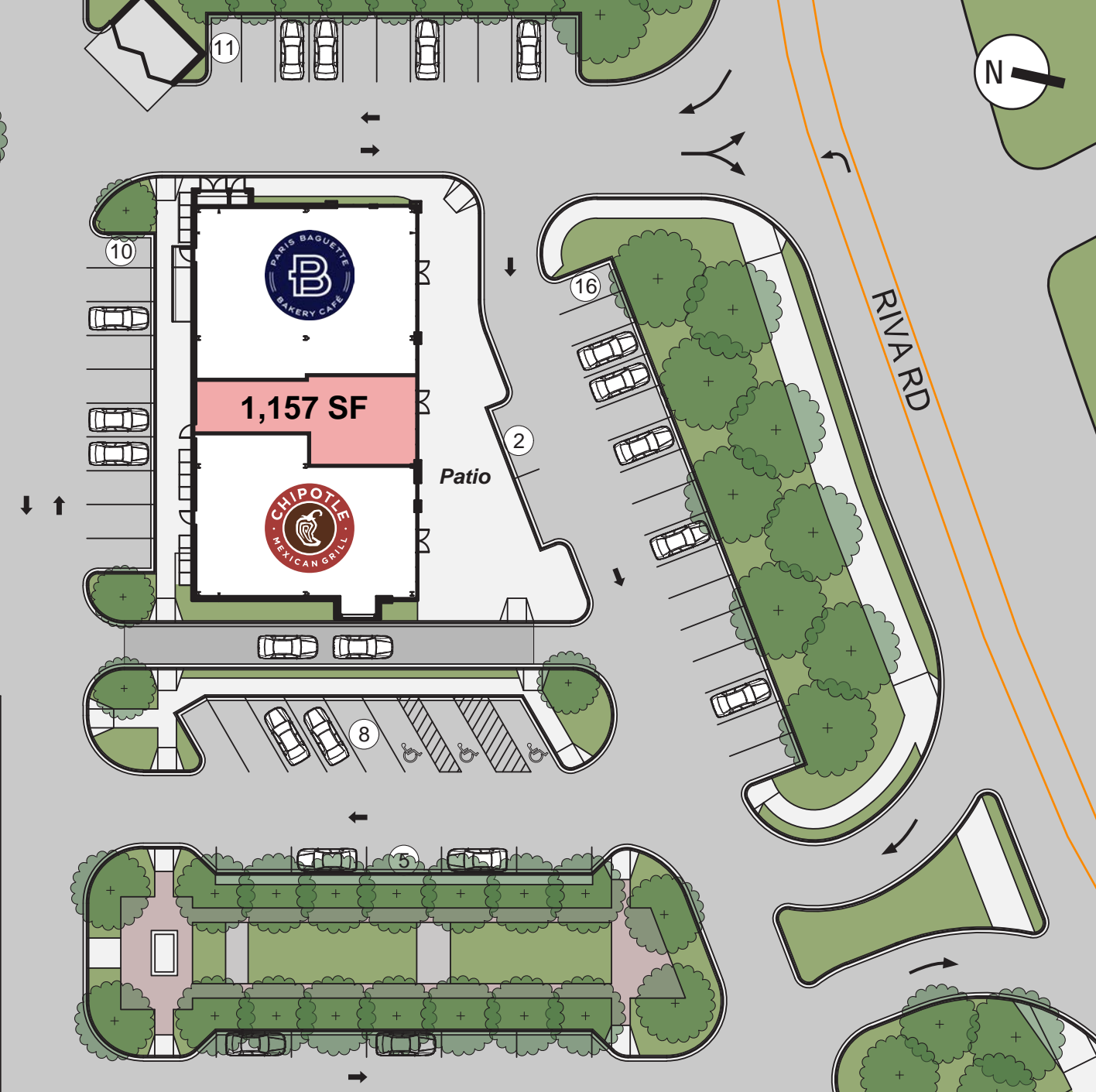
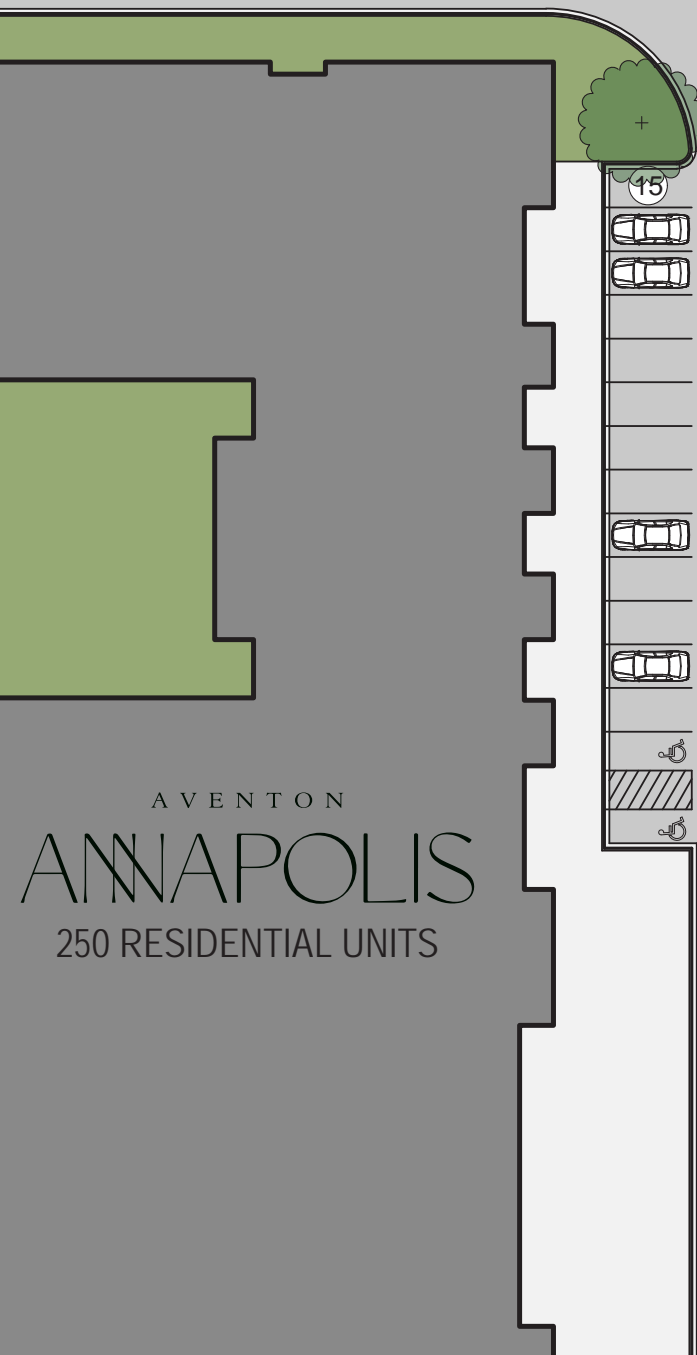

AVENTON
ANNAPOLIS
250 RESIDENTIAL UNITS

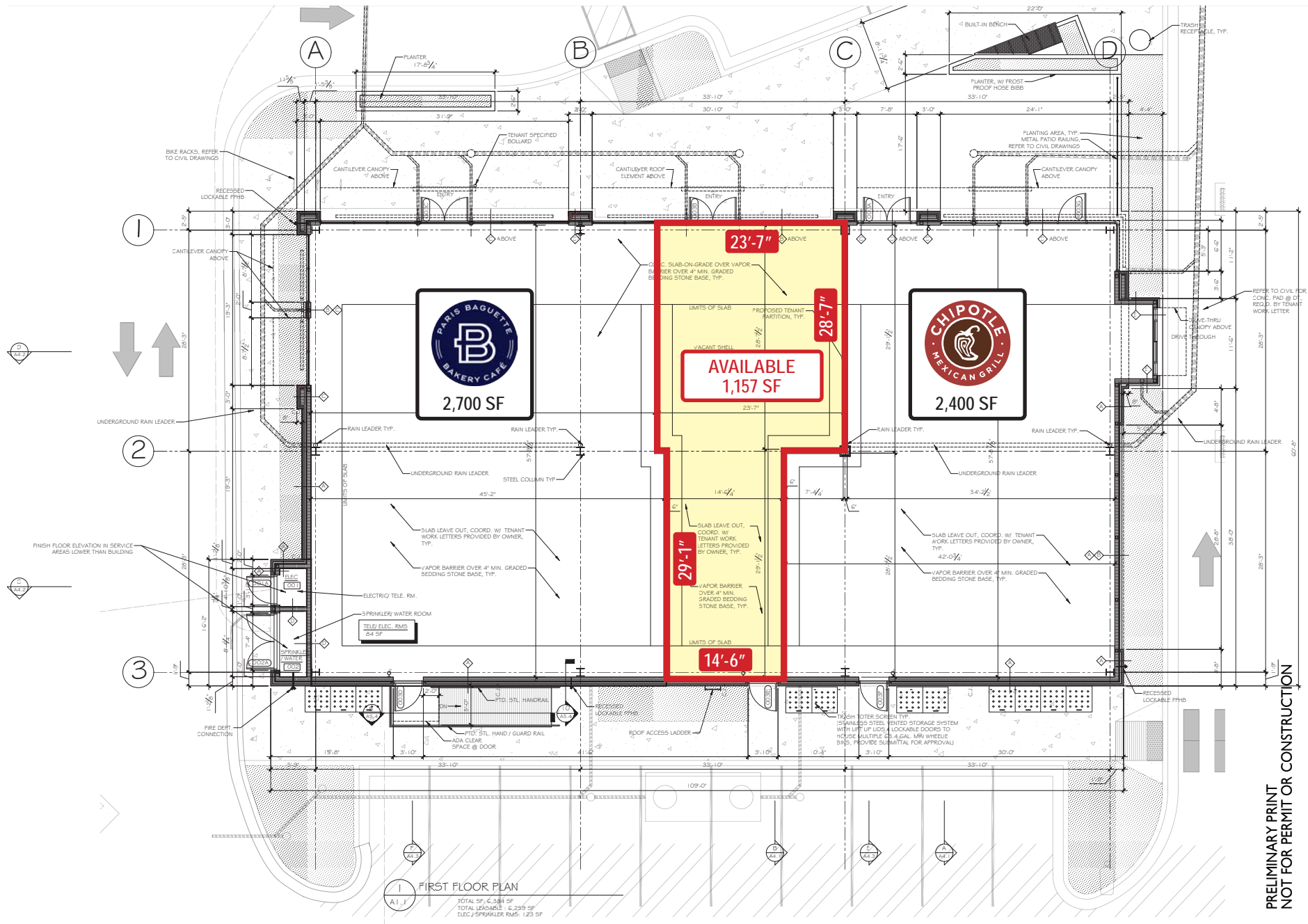

PRELIMINARY PRINT
 NOT FOR PERMIT OR CONSTRUCTION





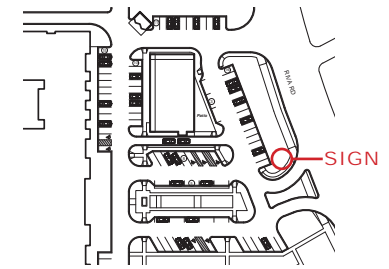
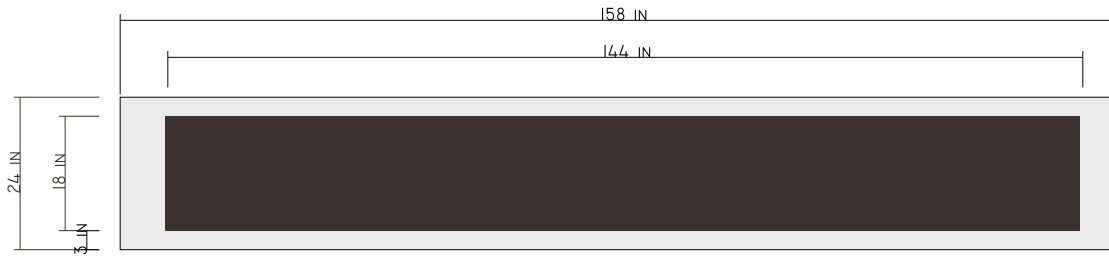

250 UNITS



- Saltwater Pool with Sunshelf
- All Fresco Dining Pergola with Electric Grills in Both Courtyards
- Grand Double Height Lobby with Water Vapor Fireplace
- Four Private Offices, Conference Room and Podcast Studio
- State-of-the-Art Fitness Center

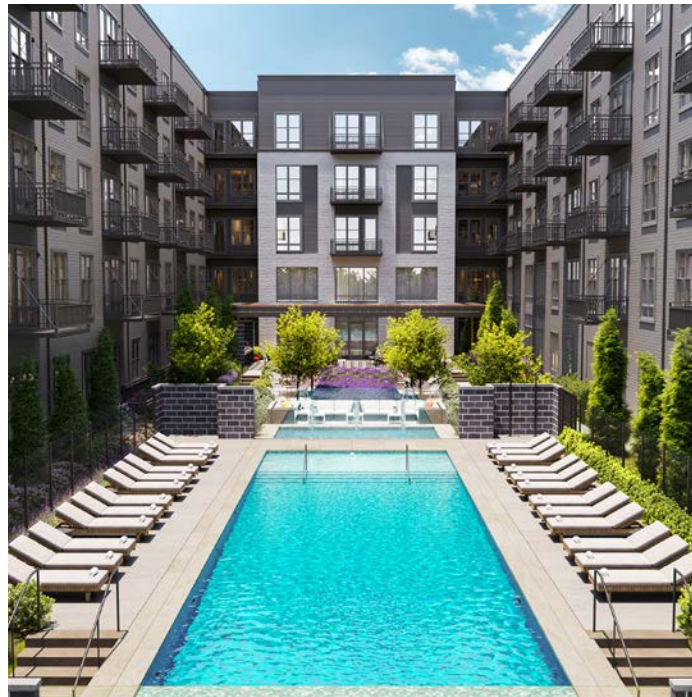
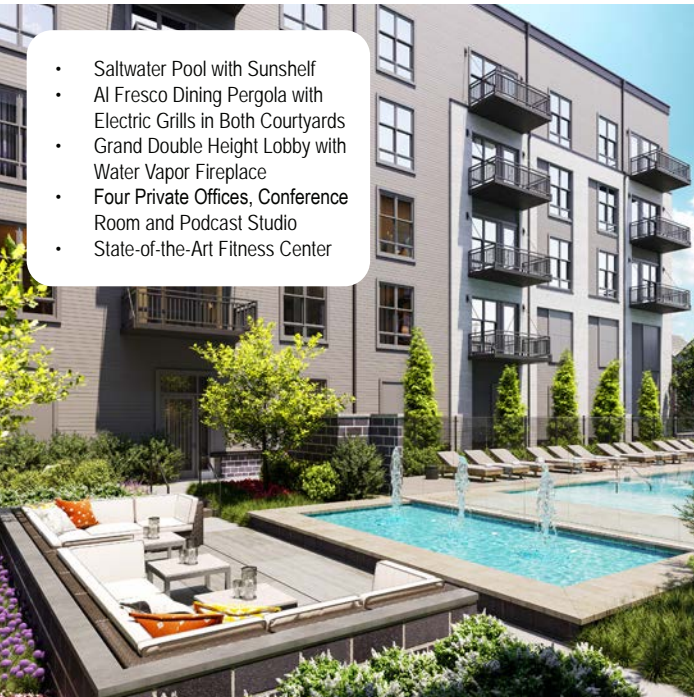

- Controlled Access Building with Parking Garage
- Electric Vehicle Charging Stations
- Smart Package System with 24/7 Access
- Pet-Friendly Community with Pet Spa and Dog Park
- Game Room with Pool Table, Shuffleboard and Arcade Games





MULTI-FAMILY DEVELOPMENT
PROPOSED

Wawa
PROPOSED

DUNKIN'

11,715 AADT

19,611 AADT

Riva Rd

2555 RIVA RD

Admiral Cochrane Dr

LOT 2
1.73 ACRES
STURBRIDGE
LUXURY TOWN HOME
DEVELOPMENT
20 UNITS
UNDER CONSTRUCTION

Chipotle
1,157 SF

LOT 3
3.85 ACRES
AVENTON
ANNAPOLIS
250 RESIDENTIAL UNITS



COURTYARD
BY MARRIOTT

**Hilton
Garden Inn**

Admiral
Suites





ANNAPOLIS HIGH SCHOOL
2,127 STUDENTS

ANNE ARUNDEL COUNTY
GOVERNMENT OFFICES

ANNE ARUNDEL COUNTY
PUBLIC SCHOOLS

MTA Maryland
EXPRESS BUS
PARK & RIDE

COURTYARD
BY HILTON
149 ROOMS

Hilton Garden Inn
126 ROOMS

Admiral Suites
97 ROOMS

SONESTA
102 ROOMS

SPRINGHILL SUITES
120 ROOMS

HOMESTYLE
Studio Suites
101 ROOMS

BEST BUY

THE HOME DEPOT

Best Western
99 ROOMS

DOUBLE TREE
219 ROOMS

Red Roof Inn
47 ROOMS

Hampton Inn
117 ROOMS

SHOPPES AT RIVA
CHICOPEE
BANK OF AMERICA

RIVA SHOPS
ALDI
QUICKWAY
honeygrow
SALON LOFTS

BEACON SQUARE
amazon
fresh
AspenDental
expectation
ARHAUS
FIREBIRDS
moby
click

ANNAPOLIS TOWN CENTRE
TARGET
WHOLE FOODS
Bassett
LIFE TIME
ETHAN ALLEN
POTTERY BARN

FOREST PLAZA
THE HOME DEPOT
DOLLAR TREE

KOHL'S
Chick-fil-A
McE Flank
meineke

Office DEPOT

ANNAPOLIS HARBOUR CENTER
THE FRESH MARKET
BARNES & NOBLE
LANDMARK THEATRES
DSW
OLD NAVY
IS A BANK
LOFT
Bath & Body Works
ATHLETA
ULTA
chico's crumby
francesca's
FLEET FEET
verizon
FRIDAYS
Palm Beach Tan
Rack
Hallmark

CROWNE PLAZA
HOTEL & RESORTS
101 ROOMS

US 50

450

Holiday Inn Express
79 ROOMS

665

2

665

2



Interested? Contact:

Jonathan Garritt

✉ jgarritt@segallgroup.com

☎ 410.753.3942

📞 443.223.0662

Andrew Segall

✉ asegall@segallgroup.com

☎ 410.753.3947

📞 443.960.0361

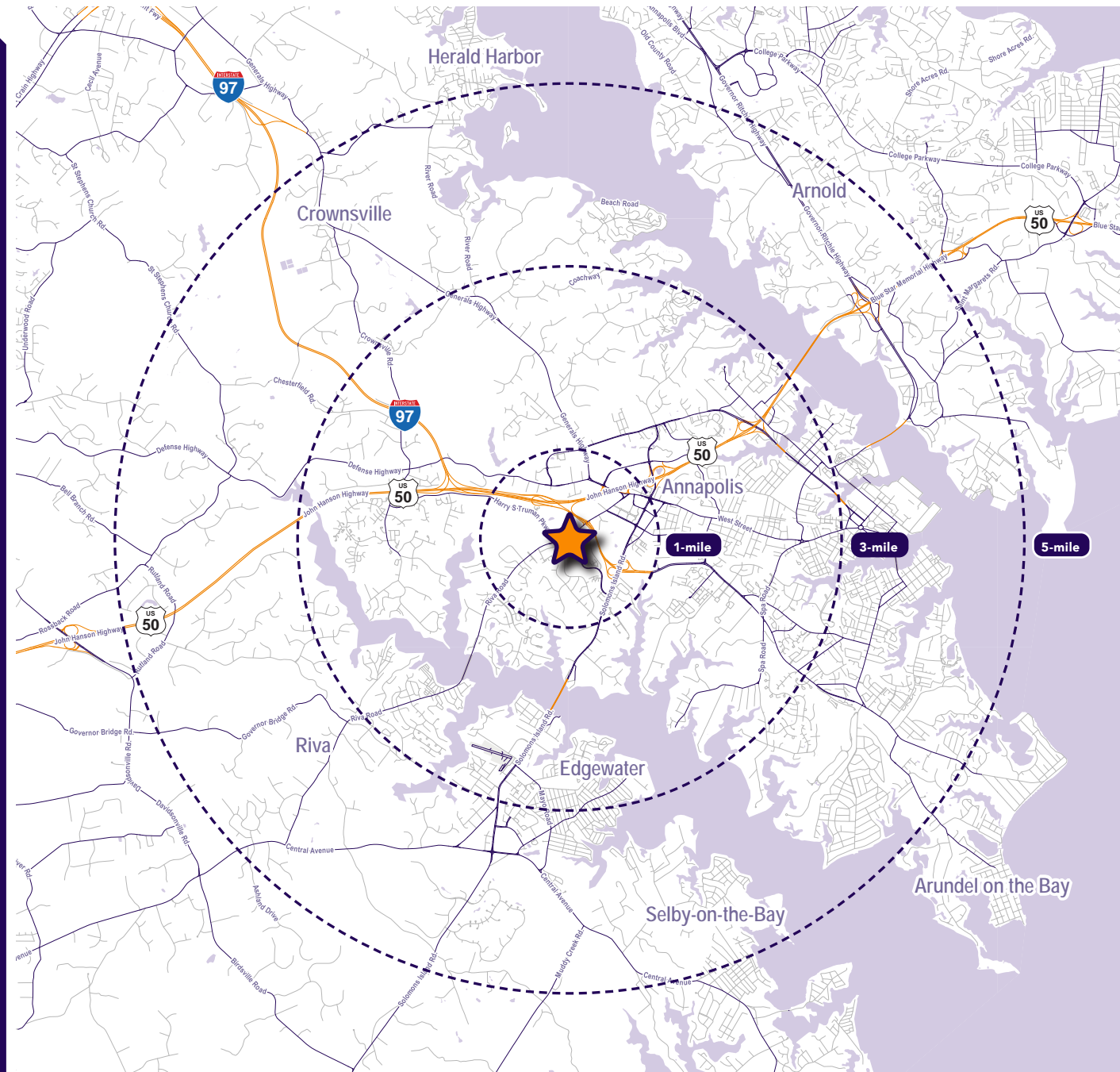

Maryland

605 South Eden Street
Suite 200
Baltimore, MD 21231
410.753.3000

DC • Northern VA

8245 Boone Boulevard
Suite 800
Tysons, VA 22182
202.833.3830

Richmond

4870 Sadler Road
Suite 300
Glen Allen, VA 23060
804.336.2501

Online

www.segallgroup.com

Member of
REALTY RESOURCES

**RETAIL
READY.**

segall
GROUP