



THE WORLD'S LARGEST CAR WASH CHAIN

Operating over 925
locations in 14 countries
across the U.S., Europe and
Australia, and more than
200 locations in the U.S.



OUR FAMILY OF BRANDS



ICWG was founded in Germany in 1965 under the IMO brand, the name still used at car wash sites outside of North America. ICWG entered the U.S. market in 2015 and operates under the Car Wash USA Express, Goo-Goo Express, Supersonic Car Wash and other various brands.

REAL ESTATE CHARACTERISTICS

DIFFERENTIATED, SCALABLE OPERATING MODEL

- Drive thru model allows customers to stay in the comfort of their car
- Compact, clean, and recognizable store design with flexible real estate requirements
- Free vacuums for all our customers
- Simple staffing model with attractive labor dynamics – specialized labor is unnecessary

REAL ESTATE METRICS

- Looking for traffic counts with +30,000 VPDs
- +25,000 population within 3 miles
- Looking for high retail density locations
- All kinds of income levels
- Looking to buy 1 AC properties but could fit as low as 0.6 AC

WHERE WE ARE TODAY & WHERE WE ARE GOING

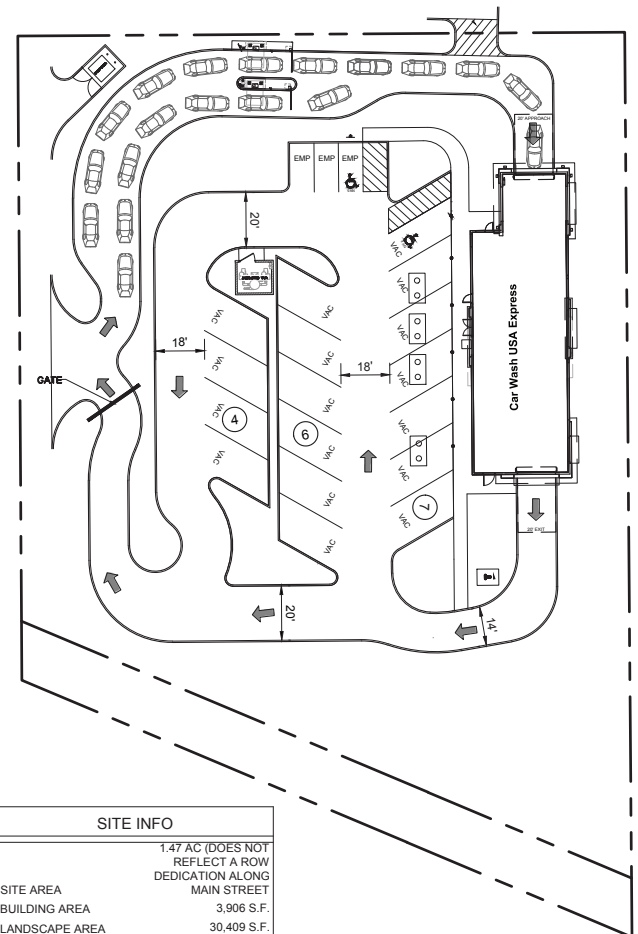
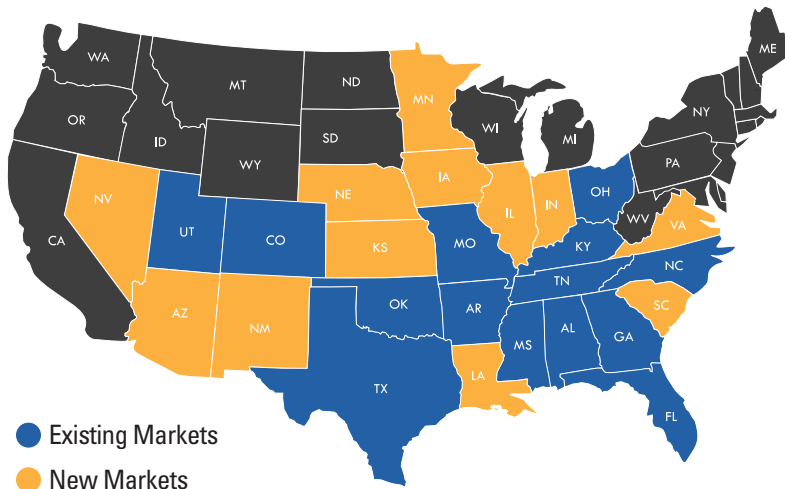

SITE INFO	
	1.47 AC (DOES NOT REFLECT A ROW DEDICATION ALONG MAIN STREET)
SITE AREA	
BUILDING AREA	3,906 S.F.
LANDSCAPE AREA	30,409 S.F.
PAVING AREA	26,460 S.F.
CAR STACKING @ XPT	12 CARS
CONVEYOR LENGTH	110'
EMPLOYEE PARKING	2 WITH 1 HC
VAC PARKING	16 WITH 1 HC

FOR MORE INFORMATION, PLEASE CONTACT:

JORGE PLANTA

Jorge.Planta@drivenbrands.com
 (919) 699-7198 | www.icwg.com