

**FOR LEASE** Available Immediately



JOIN:      **2 SPACES LEFT!**



# Centre at Glen Burnie





Glen Burnie, MD 21237

## Overview

The Centre at Glen Burnie enjoys a premiere location at the southeast corner of MD 2 (Ritchie Highway) and Ordnance Road, the dominant intersection in the Glen Burnie trade area. Target has fully renovated their store, and new anchor and shop tenants will open in 2024. Pylon signage is available, and a new access is open at Chesapeake Center Drive, providing connectivity with the neighboring Walmart Supercenter.

## Quick Facts

- Availability** Immediate
- Size** 2,856 - 7,203 square feet; Up to 38,000 square feet developable area
- Rental Rate** Negotiable
- Net Charges** CAM \$2.50 PSF; INS \$0.4 PSF; TAX \$1.25 PSF

2023 Demographics	1 mile	3 miles	5 miles
 POPULATION	<b>12,307</b>	<b>85,564</b>	<b>187,280</b>
 HOUSEHOLDS	<b>4,949</b>	<b>31,712</b>	<b>70,084</b>
 AVG. HH INCOME	<b>\$77,545</b>	<b>\$87,233</b>	<b>\$86,819</b>
 DAYTIME POPULATION	<b>10,285</b>	<b>101,035</b>	<b>215,988</b>
 TRAFFIC COUNT	<b>36,252 AADT</b> (Gov Ritchie Hwy)	<b>21,644 AADT</b> (E Ordnance Rd)	

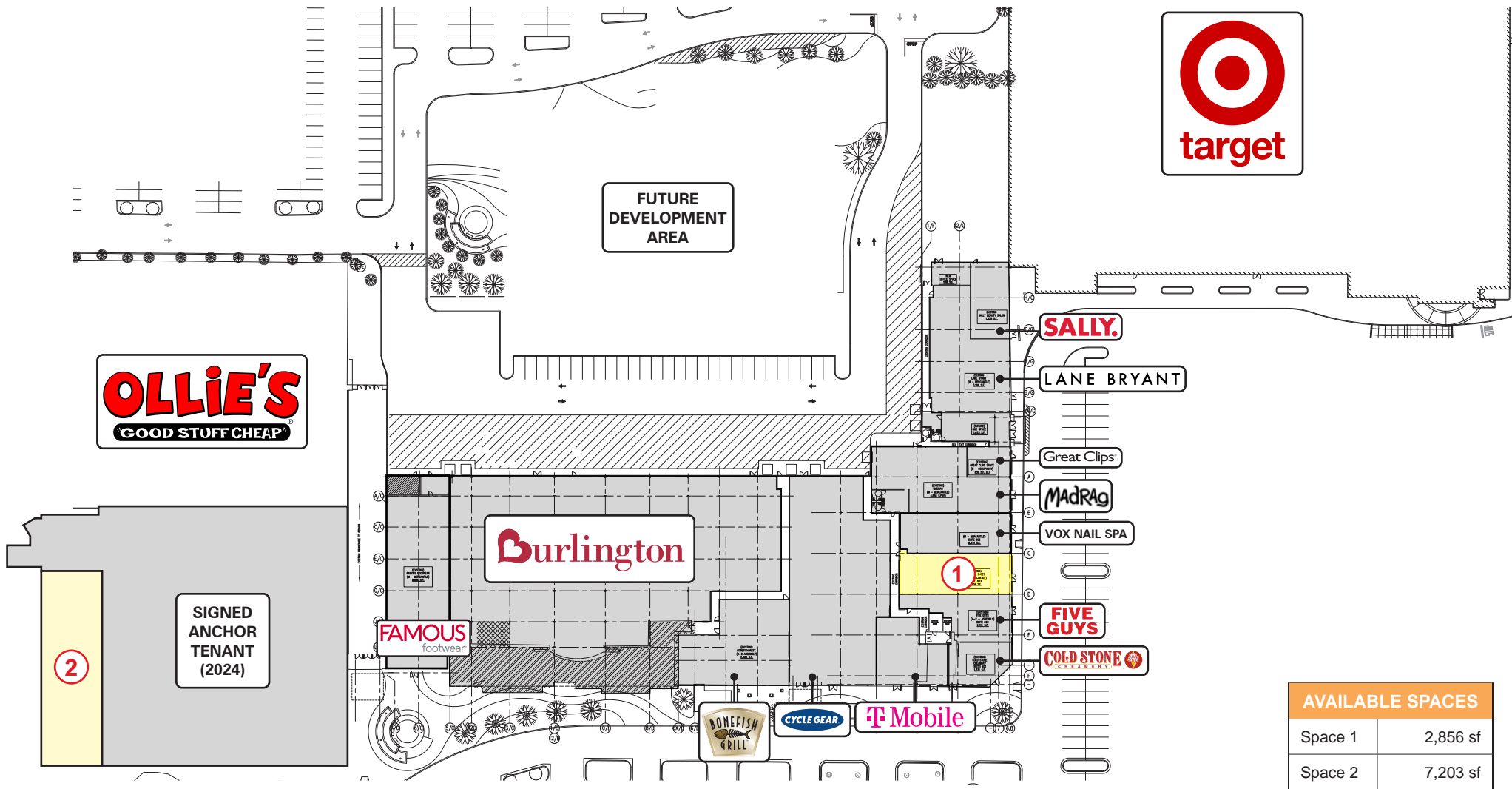

AVAILABLE SPACES	
Space 1	2,856 sf
Space 2	7,203 sf

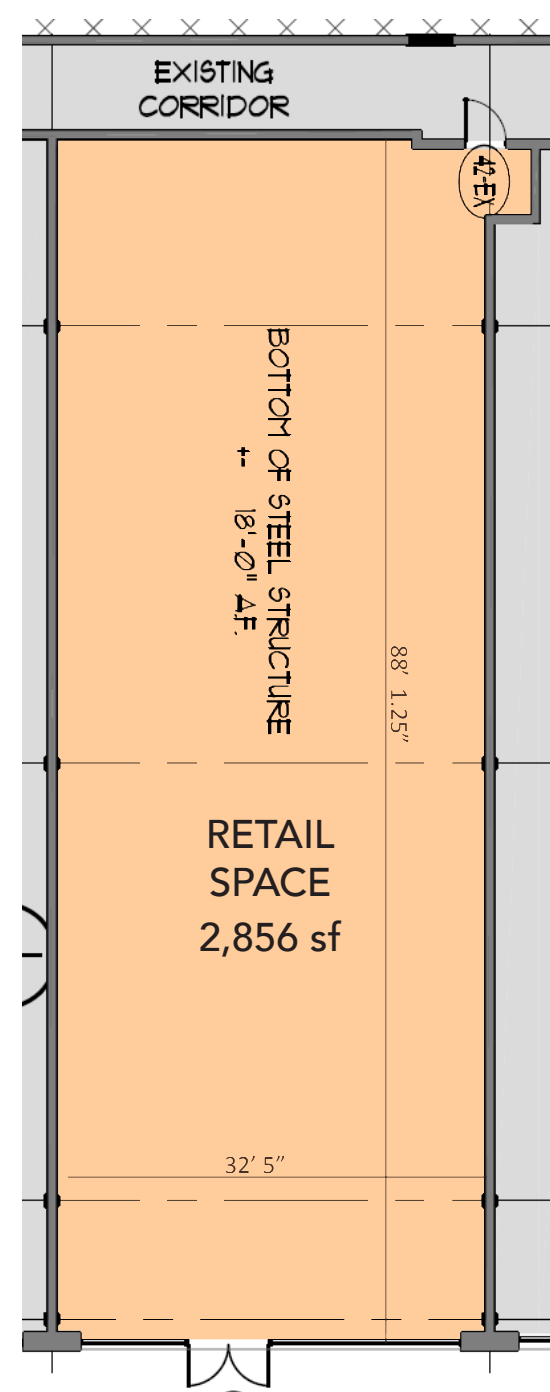

**FIVE  
GUYS**

**VOXnails**pa

## Space 1 Plan

The Centre at Glen Burnie / Governor Ritchie Highway / Glen Burnie, MD 21061

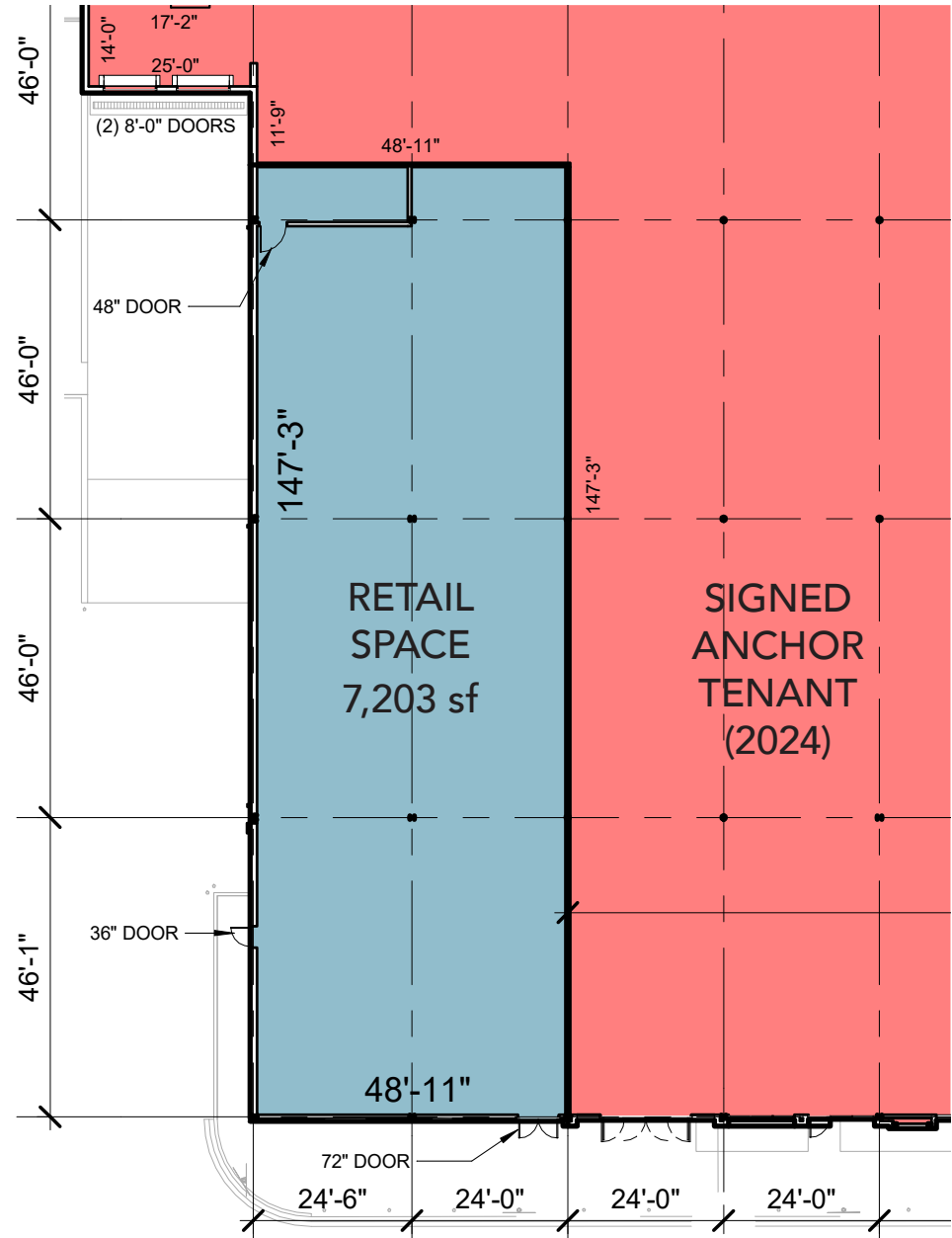
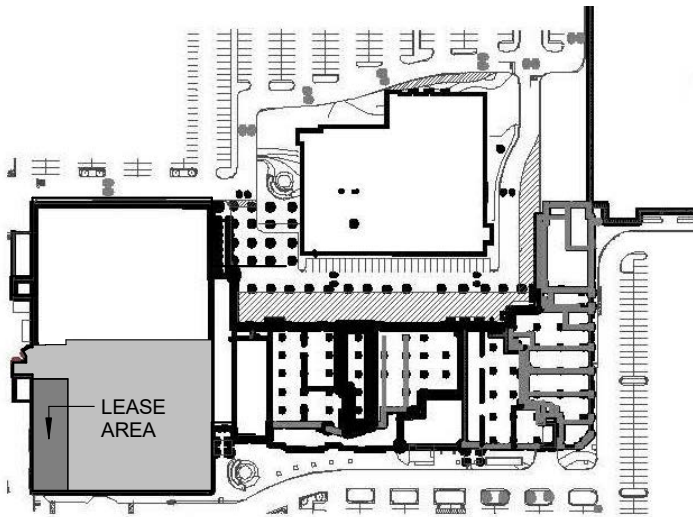



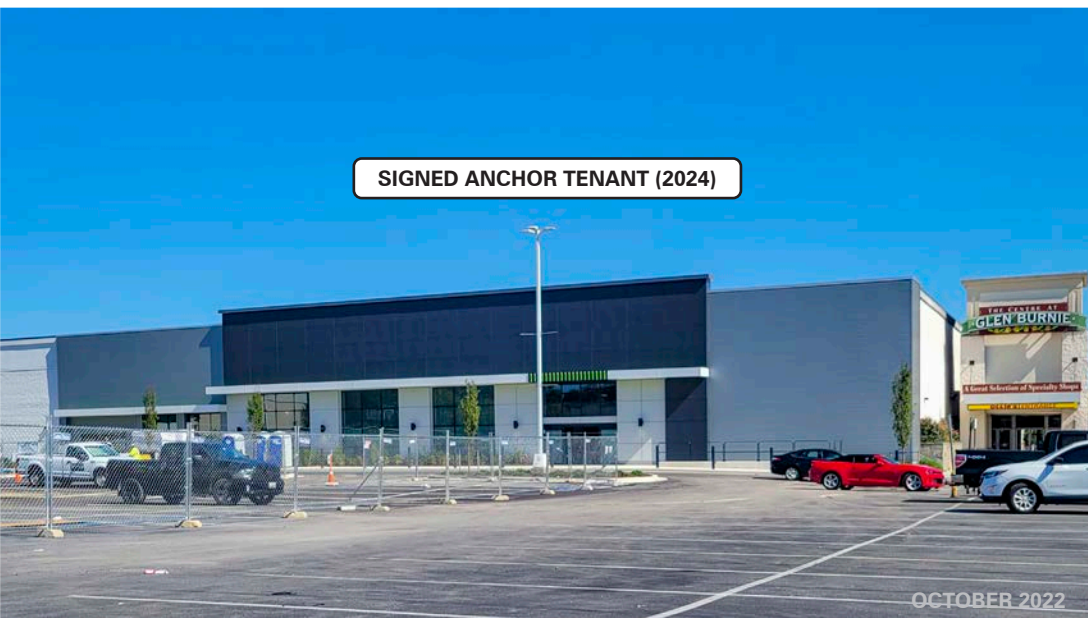

Walmart

ROUNDABOUT  
CONNECTION TO WALMART

target

SALLY'S

LANE BRYANT

Great Clips

FIVE GUYS

COLD STONE

BONEFISH GRILL

T-Mobile

CYCLE GEAR

Burlington

FAMOUS footwear

OLLIE'S  
GOOD STUFF CHEAP

FUTURE DEVELOPMENT AREA

SIGNED ANCHOR TENANT (2024)

OCTOBER 2022

segall  
GROUP

Property Photos

The Centre at Glen Burnie / Governor Ritchie Highway / Glen Burnie, MD 21061

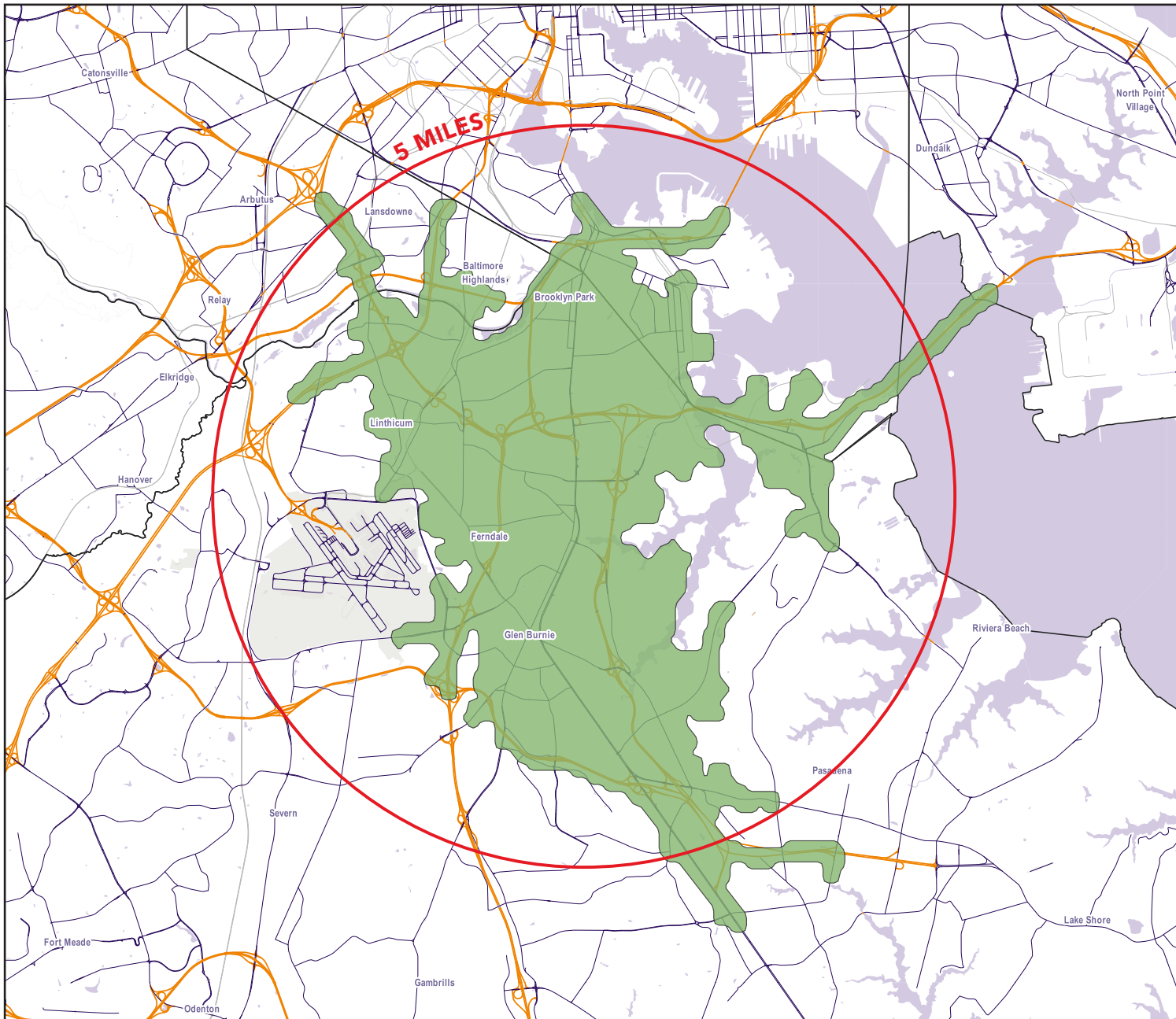

2022 Q4 DEMOGRAPHICS	TRADE AREA
Population	101,979
Households	38,921
Median HH Income	\$72,728
Daytime Population	131,727
Per Capita Income	\$33,780
Median Age	39.94
Median Home Value	\$377,603
Average HH Wealth	\$226,079
Families	35,956
Employees (16+ Years Old)	52,979
Population with Degree	21,381
Total Businesses	3,065

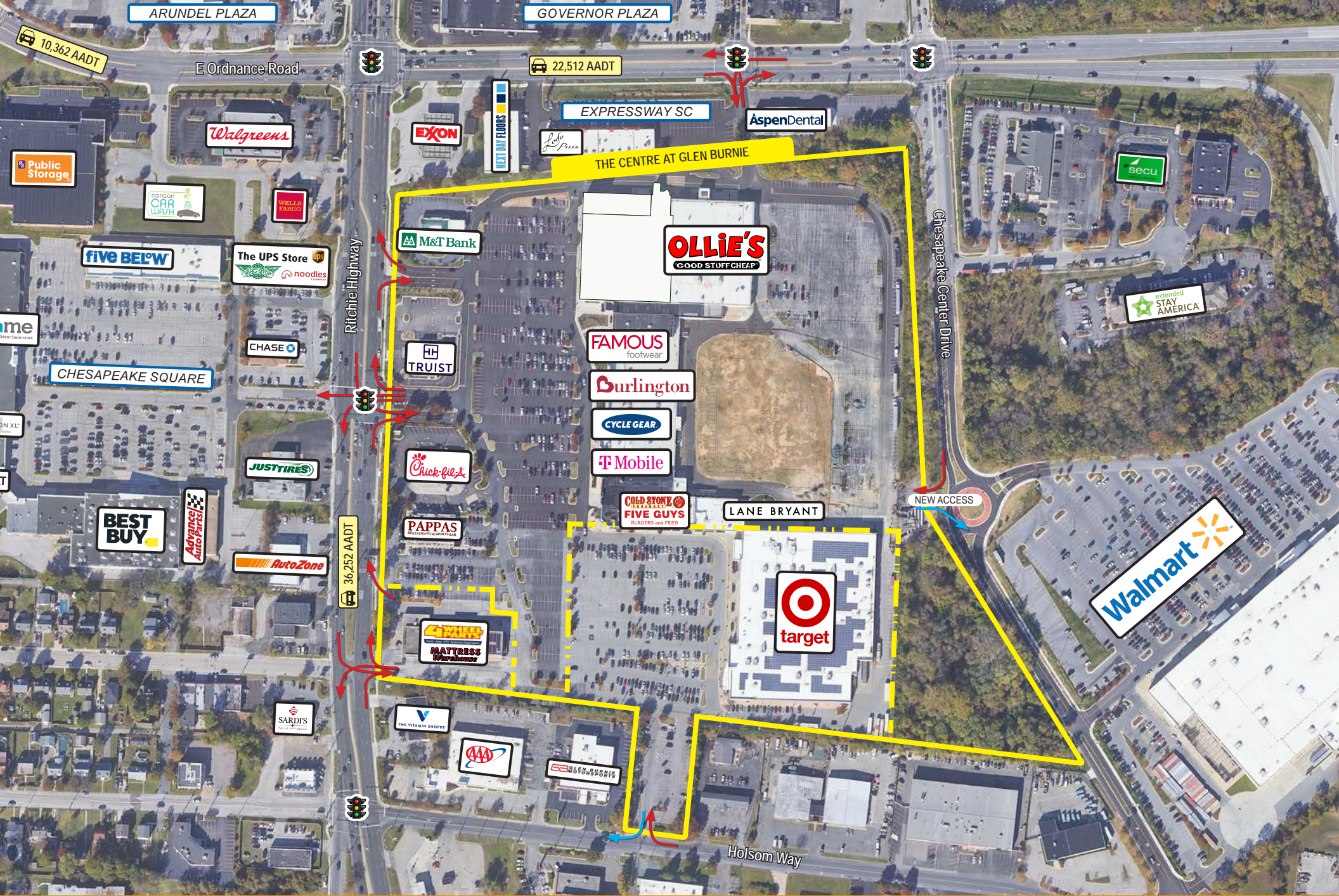



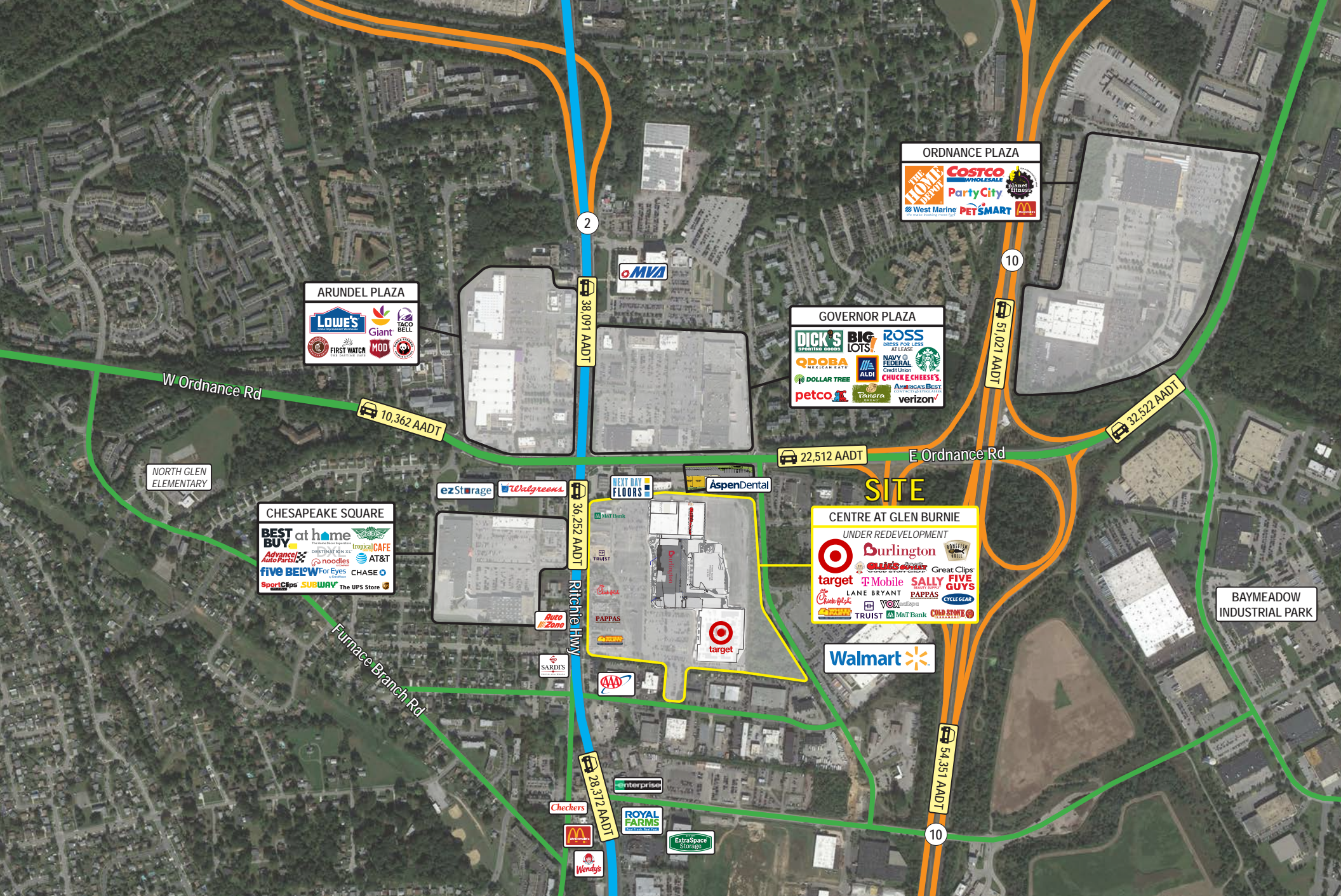

# Interested? Contact:

## Andrew Segall

✉ asegall@segallgroup.com

☎ 410.753.3947

📞 410.960.0361

## Marcelo Grosberg

✉ mgrosberg@segallgroup.com

☎ 410.753.3948

📞 443.927.6100

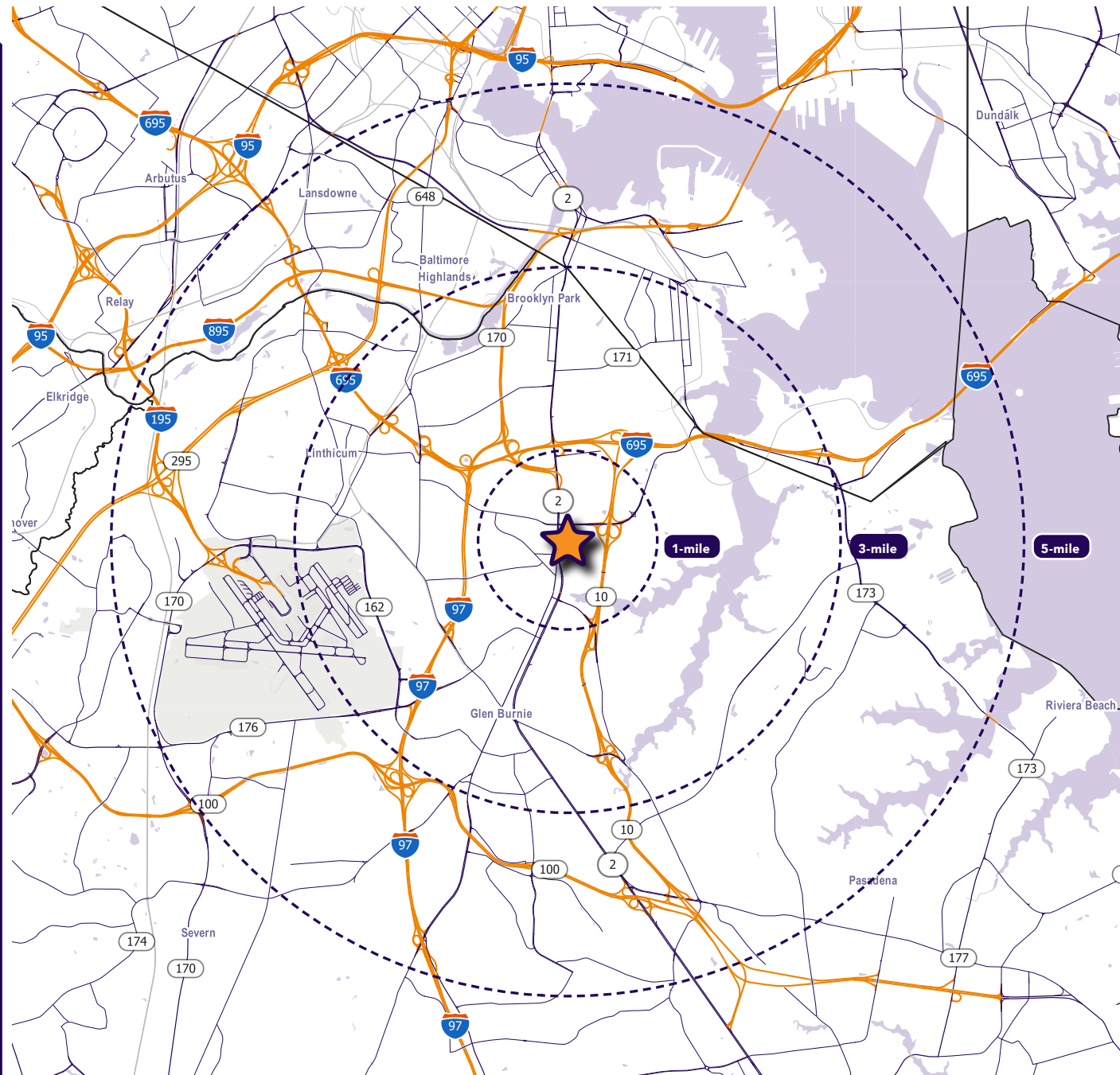

### Maryland

605 South Eden Street  
Suite 200  
Baltimore, MD 21231  
410.753.3000

### DC • Northern VA

8245 Boone Boulevard  
Suite 800  
Tysons, VA 22182  
202.833.3830

### Richmond

4870 Sadler Road  
Suite 300  
Glen Allen, VA 23060  
804.336.2501

### Online

www.segallgroup.com

Member of  
**REALTY**  
RESOURCES

**RETAIL**  
READY.